

LAND INFORMATION MEMORANDUM

Page 1

LIM No:
LIM70080262

CHRISTCHURCH
CITY COUNCIL - ENVIRONMENT

"This Land Information Memorandum has been prepared for the purpose of s.44A of the Local Government Official Information and Meetings Act 1987, and contains all the information known to the Christchurch City Council to be relevant to the land as detailed in subsection (2). It is based on a search of Council records only and there may be other information relating to the land which is unknown to the council. Council records may not show illegal or unauthorised building or works on the property. The applicant is solely responsible for ensuring that the land is suitable for a particular purpose."

Please Supply to:

SAUNDERS & CO

P O BOX 18

CHRISTCHURCH 8015

Client Reference: 715441/132

Phone No: 353-0459

Fax No: 379-3669

Date Received: 23/01/2007

Date Issued : 31/01/2007

Property Address:

32 ANNEX ROAD ADDINGTON

Legal Description:

LOT 5 DEPOSITED PLAN 349157 (DP 349157)

Valuation Roll Number: 22070 32000

Valuation Information: Rating Valuation as at 01 Aug 2004

Capital Value:\$2250000 Land Value:\$2250000 Improvements Value: \$0

*Please Note: These Values are intended for Rating purposes only***Existing Owner:**

NGAI TAHU PROPERTY LIMITED

P O BOX 130060

CHRISTCHURCH 8031

55 pages

A search of records held by the council has revealed the following information:

1. Annual rates to : 30/06/ 2007

\$11425.45

For Rates Enquiries Please Phone: 941 8423

	<u>Instalment Amount</u>	<u>Date Due</u>
Instalment 1 :	\$2856.35	31/08/2006
Instalment 2 :	\$2856.35	30/11/2006
Instalment 3 :	\$2856.35	28/02/2007
Instalment 4 :	\$2856.40	31/05/2007

Rates Owing as at : 31/01/2007 \$2856.35

2. Excess Water Charges \$0.00
3. Final water meter reading may be required YES

For Office Use:

Debtor Number: 3169557
LIM Number: LIM, 70080262
Property ID: 878057
Rate Account ID: 2699322

This Information was Processed at: Sockburn Service Centre

Telephone : (03) 941 6552

CHRISTCHURCH CITY COUNCIL
P.O. BOX 237, CHRISTCHURCH

LAND INFORMATION MEMORANDUM

2
LIM No:
LIM70080262

4. Consents Certificate, notices, orders, or requisitions affecting the land and buildings

For Building Enquiries Please Phone: 941 8995

i. Building Permits:

PER91098561 Completed

Applied: 18/06/1991 Issued Date: 28/08/1991

STAFFROOM

PER91161037 Completed

Applied: 9/09/1991 Issued Date: 09/09/1991

DRAINAGE

PER91161113 Completed

Applied: 12/09/1991 Issued Date: 12/09/1991

DRAINAGE: FOULWATER ALTERATIONS

ii. Project Information Memoranda:...None recorded for this Property**iii. Building Consents:**

ABA10014032 Completed

Applied: 29/05/2001 Issued Date: 08/06/2001

Code Compliance Certificate Issued Date: 08/08/2001

PIM Issued Date:

05/06/2001

ADDITION OF 2 RELOCATED PORTACOM UNITS - OFFICES

This Information was Processed at: **Sockburn Service Centre**CHRISTCHURCH CITY COUNCIL
P.O. BOX 237, CHRISTCHURCH

LAND INFORMATION MEMORANDUM

3

LIM No:
LIM70080262

ABA10040418 Completed Applied: 6/11/2003 Issued Date: 22/12/2003
Code Compliance Certificate Issued Date: 23/04/2004 PIM Issued Date: 28/11/2003

CHANGE OF USE: PRE-SCHOOL

ABA10040551 Completed Applied: 12/11/2003 Issued Date: 23/12/2003
Code Compliance Certificate Issued Date: 31/05/2004 PIM Issued Date: 01/12/2003

INTERNAL ALTERATION TO FERGUSSON BUILDING

ABA10052322 Completed Applied: 28/01/2005 Issued Date: 16/02/2005
Code Compliance Certificate Issued Date: 31/03/2005 PIM Issued Date: 09/02/2005

INTERNAL ALTERATIONS TO FERGUSON BUILDING - NCSP
DEPARTMENT

ABA10052532 Completed Applied: 7/02/2005 Issued Date: 16/02/2005
Code Compliance Certificate Issued Date: 02/06/2005 PIM Issued Date: 15/02/2005

REMOVAL OF 7 DWELLINGS/CUT SERVICES/13,15,17,19,21,23,2
5 ANNEX ROAD

ABA10059695 Current (In Progress) Applied: 10/10/2005 Issued Date: 17/11/2005
PIM Issued Date: 03/11/2005

DEMOLITION OF BUILDINGS ON LOTS 2 & 5

ABA10072912 Current (In Progress) Applied: 8/12/2006
PIM Issued Date: 14/09/2006

RELOCATED SALES OFFICE

CON94007417 Completed Applied: 19/08/1994 Issued Date: 02/09/1994
Code Compliance Certificate Issued Date: 06/10/1994

Pre-school climbing frame/ adv playground
commercial/ preschool climbing frame/
adventure playground

This Information was Processed at: Sockburn Service Centre

CHRISTCHURCH CITY COUNCIL
P.O. BOX 237, CHRISTCHURCH

LAND INFORMATION MEMORANDUM4
LIM No:
LIM70080262

CON98006649 Completed

Applied: 20/08/1998 Issued Date: 01/09/1998

Code Compliance Certificate Issued Date: 08/10/1998

Relocate staff room building assembly care/
relocate staff room building

iv. Building Act Certificates of Acceptance: ...None recorded for this Property

v. Building Act Exemptions:

BAE35000727 DECLINED

Applied: 21/01/2005

Exemption Declined Date:

Application for exemption from Building Consent for alterations to Fergusson Building

vi. Registered Premises: ...None recorded for this Property

vii. Hazardous Substance Test Certificate: ...None recorded for this Property

viii. Building Warrant Of Fitness:

WOF31642

Expires: 1/05/2007

Compliance Schedule

Warrant of Fitness/Statement of Fitness/Compliance Schedule Statement

This Information was Processed at: **Sockburn Service Centre**

CHRISTCHURCH CITY COUNCIL
P.O. BOX 237, CHRISTCHURCH

LAND INFORMATION MEMORANDUM



5
LIM No:
LIM70080262

5. Planning Information:

For Planning Enquiries Please Phone: 941 8999

(A) Transitional Plan

(B) Proposed Plan

Zoning

CHB (Hospital Purposes)
Hairpin

Designations on Site

Yes/No

Road Widening Designations

Yes/No

Zoning

Special Purpose (Hospital)

- | | |
|------------------------------------|-----|
| 1. Special Amenity Area | No |
| 2. Community Footprint | No |
| 3. Opposite Important Open Space | No |
| 4. Designations on Site | No |
| 5. Road Widening Designations | No |
| 6. Historic or Protected Bldg | Yes |
| 7. Other Heritage Protection Items | No |
| 8. Protected Trees | |
| - Heritage/Notable Tree | Yes |
| - Other eg. Category A,B,C | Yes |
| Street Plantings, Subdivision | |
| Trees | |
| 9. Noise Control | No |
| 10. Coastal Protection | No |
| 11. Landscape Protection | No |

Note - The Council is not required to include all information in a LIM that is apparent from the Transitional District Plan or the Proposed City Plan. However it is this Council's current practice to include planning information that it considers will be helpful to the LIM applicant. Please note that the planning information provided is not exhaustive, and reference to the Transitional District Plan and the Proposed City Plan is recommended.

(C) Land Use Resource Consents

RMA20003684 Completed

Applied: 23/11/2000

Application Granted, Consent Issued : 29/03/2001

FEE SIMPLE SUBDIVISION - 72 LOTS

This Information was Processed at: Sockburn Service Centre

CHRISTCHURCH CITY COUNCIL
P.O. BOX 237, CHRISTCHURCH

LAND INFORMATION MEMORANDUM

6
LIM No:
LIM70080262

RMA20015287 Completed Applied: 6/11/2003
Application Granted, Consent Issued : 23/01/2004

Application to establish and operate a pre-school
and retrospective sign at the corner of Annex Road
and Lincoln Road

RMA20015782 Completed Applied: 13/01/2004
Application Granted, Consent Issued : 25/02/2004

BOUNDARY ADJUSTMENT
223 requested 15/2/05 issued 10/03/05
224 Requested 21/03/05 Issued 28/4/5 DP 349157

RMA92004916 Current (In Progress) Applied: 26/04/2006

Fee Simple Subdivision

RMA92005845 Completed Applied: 31/07/2006
Application Granted, Consent Issued : 29/09/2006

To erect three temporary freestanding signs

6. Information notified to council by any statutory organisation having the power to classify land or building for any purpose:.....Yes

Please refer to Section 9 for details

7. Information notified to council by any network utility operator pursuant to the Building Act 1991:.....No

8. Refuse

The 26 bags which the council provides each year are for the refuse generated on that property during the year. When moving house (or flat) all refuse bags should be left behind for the new owners. There should be enough to last until next May.

- ◆ Your recycling is Collected Weekly on Tuesday Leave your recycling at the Kerbside by 7:30 a.m.
Your nearest recycling depot is the Parkhouse Road Refuse Station
- ◆ Your refuse is Collected Weekly on Tuesday Leave your refuse at the Kerbside by 7:30 a.m.
Your nearest refuse depot is the Parkhouse Road Refuse Station

This Information was Processed at: **Sockburn Service Centre**

CHRISTCHURCH CITY COUNCIL
P.O. BOX 237, CHRISTCHURCH

LAND INFORMATION MEMORANDUM7
LIM No:
LIM70080262**9. Other Related Property Information****◆ City Plan Variation 48**

This property is in an area affected by the City Plan Variation #48 regarding Flood Management. Should any development on this site be proposed, early consultation with a council planner is advised. Ph 941 8657.

◆ Development Constraint Conditions

Council records show there is a specific condition on the use of this site:
Water Supply conditions

◆ Development Constraint Conditions

Council records show there is a specific condition on the use of this site:
Constraints Relating to Sewage

◆ ECan Liquefaction Assessment 1

This property is in the 2004 Stage IV ECan liquefaction risk study area and the report identified areas with a potential susceptibility for liquefaction and related lateral spread and subsidence. All queries regarding this information should be made to ECan on Ph 03 353 9007 or via the ECan website www.ecan.govt.nz
<<http://www.ecan.govt.nz>>.

◆ ECan Liquefaction Assessment 2

Council may require further specific site investigation before granting any future subdivision or building consent for this property. The classification of the liquefaction potential are indicative only given the limited information within the study area.

◆ ECan Natural Resources Regional Plan

The Proposed Natural Resources Regional Plan notified by ECan in July 2004 has classified this site and there may be policies or rules within the NRRP that regulate the use of this site in regard to a proposed land use. Council has not and cannot verify the accuracy of such information and its impact on and applicability to the property, and advises LIM applicants to consult with Ecan and independent advisers about the direct impact of the NRRP on the subject property. All queries regarding this information should be made to ECan on Ph 03 353 9007.

◆ Historic or Protected Building

This is a heritage building, place or object, and is subject to rules in the Christchurch City Plan or the Banks Peninsula District Plan. If you are proposing to change the building or site, a resource consent is likely to be required. Some of the information may not be accurate and early consultation with the Christchurch City Council heritage team is recommended on Ph. 941-8643.

This Information was Processed at: **Sockburn Service Centre**

CHRISTCHURCH CITY COUNCIL
P.O. BOX 237, CHRISTCHURCH

LAND INFORMATION MEMORANDUM



8

LIM No:
LIM70080262

- ◆ **Property Records are held at the Sockburn Service Centre**

- ◆ **Property located in Spreydon-Heathcote Community Board area**

- ◆ **Property located in Spreydon-Heathcote Ward**

- ◆ **Property or part of property within urban area**

- ◆ **Tree protected by City Plan (Notable) contained within this property**
 This site contains a Heritage or Notable tree(s) listed in the City Plan and the tree(s) are protected by rules in the plan. If you are proposing to undertake any works within 10 metres of the tree(s) a resource consent is required and early consultation with council planning staff is recommended.
 Species Name: *Fagus sylvatica Purpurca* Common Name: Copper Beech
 Crown Width(m)12 Height(m): 14

- ◆ **Tree protected by City Plan (Notable) contained within this property**
 This site contains a Heritage or Notable tree(s) listed in the City Plan and the tree(s) are protected by rules in the plan. If you are proposing to undertake any works within 10 metres of the tree(s) a resource consent is required and early consultation with council planning staff is recommended.
 Species Name: *Quercus palustris* Common Name: Pin Oak
 Crown Width(m)15 Height(m): 16

- ◆ **Tree protected by City Plan (Notable) contained within this property**
 This site contains a Heritage or Notable tree(s) listed in the City Plan and the tree(s) are protected by rules in the plan. If you are proposing to undertake any works within 10 metres of the tree(s) a resource consent is required and early consultation with council planning staff is recommended.
 Species Name: *Tilia x vulgaris* Common Name: Common Lime
 Crown Width(m)11 Height(m): 13

This Information was Processed at: **Sockburn Service Centre**

CHRISTCHURCH CITY COUNCIL
P.O. BOX 237, CHRISTCHURCH

LAND INFORMATION MEMORANDUM



9
LIM No:
LIM70080262

- ◆ **Tree protected by City Plan (Notable) contained within this property**
This site contains a Heritage or Notable tree(s) listed in the City Plan and the tree(s) are protected by rules in the plan. If you are proposing to undertake any works within 10 metres of the tree(s) a resource consent is required and early consultation with council planning staff is recommended.
Species Name: Quercus robur Common Name: English Oak
Crown Width(m)24 Height(m): 19
- ◆ **Tree protected by City Plan (Notable) contained within this property**
This site contains a Heritage or Notable tree(s) listed in the City Plan and the tree(s) are protected by rules in the plan. If you are proposing to undertake any works within 10 metres of the tree(s) a resource consent is required and early consultation with council planning staff is recommended.
Species Name: Castanea sativa Common Name: Sweet Chestnut
Crown Width(m)13 Height(m): 12
- ◆ **Tree protected by City Plan (Notable) contained within this property**
This site contains a Heritage or Notable tree(s) listed in the City Plan and the tree(s) are protected by rules in the plan. If you are proposing to undertake any works within 10 metres of the tree(s) a resource consent is required and early consultation with council planning staff is recommended.
Species Name: Tilia x vulgaris Common Name: Common Lime
Crown Width(m)16 Height(m): 20
- ◆ **Tree protected by City Plan (Notable) contained within this property**
This site contains a Heritage or Notable tree(s) listed in the City Plan and the tree(s) are protected by rules in the plan. If you are proposing to undertake any works within 10 metres of the tree(s) a resource consent is required and early consultation with council planning staff is recommended.
Species Name: Tilia cordata Common Name: Small-leaved Lime
Crown Width(m)12 Height(m): 14
- ◆ **Tree protected by City Plan (Notable) contained within this property**
This site contains a Heritage or Notable tree(s) listed in the City Plan and the tree(s) are protected by rules in the plan. If you are proposing to undertake any works within 10 metres of the tree(s) a resource consent is required and early consultation with council planning staff is recommended.
Species Name: Abies pinsapo Common Name: Spanish Fir
Crown Width(m)11 Height(m): 17
- ◆ **Tree protected by City Plan (Notable) contained within this property**
This site contains a Heritage or Notable tree(s) listed in the City Plan and the tree(s) are protected by rules in the plan. If you are proposing to undertake any works within 10 metres of the tree(s) a resource consent is required and early consultation with council planning staff is recommended.
Species Name: Tilia x vulgaris Common Name: Common Lime
Crown Width(m)11 Height(m): 14
- ◆ **Tree protected by City Plan (Notable) contained within this property**
This site contains a Heritage or Notable tree(s) listed in the City Plan and the tree(s) are protected by rules in the plan. If you are proposing to undertake any works within 10 metres of the tree(s) a resource consent is required and early consultation with council planning staff is recommended.
Species Name: Aesculus hippocastanum Common Name: Horse Chestnut
Crown Width(m)21 Height(m): 10

This Information was Processed at: **Sockburn Service Centre**

LAND INFORMATION MEMORANDUM



10
LIM No:
LIM70080262

- ◆ **Tree protected by City Plan (Notable) contained within this property**
This site contains a Heritage or Notable tree(s) listed in the City Plan and the tree(s) are protected by rules in the plan. If you are proposing to undertake any works within 10 metres of the tree(s) a resource consent is required and early consultation with council planning staff is recommended.
Species Name: Quercus robur Common Name: English Oak
Crown Width(m)17 Height(m): 14
- ◆ **Tree protected by City Plan (Notable) contained within this property**
This site contains a Heritage or Notable tree(s) listed in the City Plan and the tree(s) are protected by rules in the plan. If you are proposing to undertake any works within 10 metres of the tree(s) a resource consent is required and early consultation with council planning staff is recommended.
Species Name: Tilia x vulgaris Common Name: Common Lime
Crown Width(m)14 Height(m): 17
- ◆ **Tree protected by City Plan (Notable) contained within this property**
This site contains a Heritage or Notable tree(s) listed in the City Plan and the tree(s) are protected by rules in the plan. If you are proposing to undertake any works within 10 metres of the tree(s) a resource consent is required and early consultation with council planning staff is recommended.
Species Name: Thuja plicata Common Name: Western Red Cedar
Crown Width(m)11 Height(m): 21
- ◆ **Tree protected by City Plan (Notable) contained within this property**
This site contains a Heritage or Notable tree(s) listed in the City Plan and the tree(s) are protected by rules in the plan. If you are proposing to undertake any works within 10 metres of the tree(s) a resource consent is required and early consultation with council planning staff is recommended.
Species Name: Tilia x vulgaris Common Name: Common Lime
Crown Width(m)14 Height(m): 17
- ◆ **Tree protected by City Plan (Notable) contained within this property**
This site contains a Heritage or Notable tree(s) listed in the City Plan and the tree(s) are protected by rules in the plan. If you are proposing to undertake any works within 10 metres of the tree(s) a resource consent is required and early consultation with council planning staff is recommended.
Species Name: Thuja plicata Common Name: Western Red Cedar
Crown Width(m)14 Height(m): 16
- ◆ **Tree protected by City Plan (Notable) contained within this property**
This site contains a Heritage or Notable tree(s) listed in the City Plan and the tree(s) are protected by rules in the plan. If you are proposing to undertake any works within 10 metres of the tree(s) a resource consent is required and early consultation with council planning staff is recommended.
Species Name: Liriodendron tulipifera Common Name: Tulip Tree
Crown Width(m)19 Height(m): 17
- ◆ **Tree protected by City Plan (Notable) contained within this property**
This site contains a Heritage or Notable tree(s) listed in the City Plan and the tree(s) are protected by rules in the plan. If you are proposing to undertake any works within 10 metres of the tree(s) a resource consent is required and early consultation with council planning staff is recommended.
Species Name: Cedrus atlantica Common Name: Atlas Cedar
Crown Width(m)11 Height(m): 14

This Information was Processed at: Sockburn Service Centre

CHRISTCHURCH CITY COUNCIL
P.O. BOX 237, CHRISTCHURCH

LAND INFORMATION MEMORANDUM



11
LIM No:
LIM70080262

- ◆ **Tree protected by City Plan (Notable) contained within this property**
This site contains a Heritage or Notable tree(s) listed in the City Plan and the tree(s) are protected by rules in the plan. If you are proposing to undertake any works within 10 metres of the tree(s) a resource consent is required and early consultation with council planning staff is recommended.
Species Name: *Chamaecyparis lawsoniana* Common Name: Lawson Cypress
Crown Width(m)13 Height(m): 20
- ◆ **Tree protected by City Plan (Notable) contained within this property**
This site contains a Heritage or Notable tree(s) listed in the City Plan and the tree(s) are protected by rules in the plan. If you are proposing to undertake any works within 10 metres of the tree(s) a resource consent is required and early consultation with council planning staff is recommended.
Species Name: *Sophora japonica* Common Name: Japanese Pagoda Tree
Crown Width(m)18 Height(m): 16
- ◆ **Tree protected by City Plan (Notable) contained within this property**
This site contains a Heritage or Notable tree(s) listed in the City Plan and the tree(s) are protected by rules in the plan. If you are proposing to undertake any works within 10 metres of the tree(s) a resource consent is required and early consultation with council planning staff is recommended.
Species Name: *Photinia glabra* Common Name: Japanese Photinia
Crown Width(m)15 Height(m): 14
- ◆ **Tree protected by City Plan (Notable) contained within this property**
This site contains a Heritage or Notable tree(s) listed in the City Plan and the tree(s) are protected by rules in the plan. If you are proposing to undertake any works within 10 metres of the tree(s) a resource consent is required and early consultation with council planning staff is recommended.
Species Name: *Tilia x vulgaris* Common Name: Common Lime
Crown Width(m)12 Height(m): 15
- ◆ **Tree protected by City Plan (Notable) contained within this property**
This site contains a Heritage or Notable tree(s) listed in the City Plan and the tree(s) are protected by rules in the plan. If you are proposing to undertake any works within 10 metres of the tree(s) a resource consent is required and early consultation with council planning staff is recommended.
Species Name: *Tilia x vulgaris* Common Name: Common Lime
Crown Width(m)11 Height(m): 14
- ◆ **Tree protected by City Plan (Notable) contained within this property**
This site contains a Heritage or Notable tree(s) listed in the City Plan and the tree(s) are protected by rules in the plan. If you are proposing to undertake any works within 10 metres of the tree(s) a resource consent is required and early consultation with council planning staff is recommended.
Species Name: *Magnolia grandiflora* Common Name: Southern Magnolia
Crown Width(m)11 Height(m): 10
- ◆ **Tree protected by City Plan (Notable) contained within this property**
This site contains a Heritage or Notable tree(s) listed in the City Plan and the tree(s) are protected by rules in the plan. If you are proposing to undertake any works within 10 metres of the tree(s) a resource consent is required and early consultation with council planning staff is recommended.
Species Name: *Thuja plicata* Common Name: Western Red Cedar
Crown Width(m)11 Height(m): 19

This Information was Processed at: **Sockburn Service Centre**

LAND INFORMATION MEMORANDUM



12

LIM No:
LIM70080262

- ◆ **Tree protected by City Plan (Notable) contained within this property**
 This site contains a Heritage or Notable tree(s) listed in the City Plan and the tree(s) are protected by rules in the plan. If you are proposing to undertake any works within 10 metres of the tree(s) a resource consent is required and early consultation with council planning staff is recommended.
 Species Name: *Hoheria angustifolia* Common Name: Narrow-leaved Lacebark
 Crown Width(m)12 Height(m): 13
- ◆ **Tree protected by City Plan (Notable) contained within this property**
 This site contains a Heritage or Notable tree(s) listed in the City Plan and the tree(s) are protected by rules in the plan. If you are proposing to undertake any works within 10 metres of the tree(s) a resource consent is required and early consultation with council planning staff is recommended.
 Species Name: *Aesculus x carnea* Common Name: Pink Horse Chestnut
 Crown Width(m)15 Height(m): 11
- ◆ **Tree protected by City Plan (Notable) contained within this property**
 This site contains a Heritage or Notable tree(s) listed in the City Plan and the tree(s) are protected by rules in the plan. If you are proposing to undertake any works within 10 metres of the tree(s) a resource consent is required and early consultation with council planning staff is recommended.
 Species Name: *Quercus robur* Common Name: English Oak
 Crown Width(m)15 Height(m): 17
- ◆ **Tree protected by City Plan (Notable) contained within this property**
 This site contains a Heritage or Notable tree(s) listed in the City Plan and the tree(s) are protected by rules in the plan. If you are proposing to undertake any works within 10 metres of the tree(s) a resource consent is required and early consultation with council planning staff is recommended.
 Species Name: *Quercus robur* Common Name: English Oak
 Crown Width(m)14 Height(m): 16
- ◆ **Tree protected by City Plan (Notable) contained within this property**
 This site contains a Heritage or Notable tree(s) listed in the City Plan and the tree(s) are protected by rules in the plan. If you are proposing to undertake any works within 10 metres of the tree(s) a resource consent is required and early consultation with council planning staff is recommended.
 Species Name: *Quercus palustris* Common Name: Pin Oak
 Crown Width(m)15 Height(m): 16
- ◆ **Tree protected by City Plan (Notable) contained within this property**
 This site contains a Heritage or Notable tree(s) listed in the City Plan and the tree(s) are protected by rules in the plan. If you are proposing to undertake any works within 10 metres of the tree(s) a resource consent is required and early consultation with council planning staff is recommended.
 Species Name: *Fraxinus excelsior* Common Name: English Ash
 Crown Width(m)18 Height(m): 15
- ◆ **Tree protected by City Plan (Notable) contained within this property**
 This site contains a Heritage or Notable tree(s) listed in the City Plan and the tree(s) are protected by rules in the plan. If you are proposing to undertake any works within 10 metres of the tree(s) a resource consent is required and early consultation with council planning staff is recommended.
 Species Name: *Quercus robur* Common Name: English Oak
 Crown Width(m)15 Height(m): 13

This Information was Processed at: **Sockburn Service Centre**

CHRISTCHURCH CITY COUNCIL
 P.O. BOX 237, CHRISTCHURCH

LAND INFORMATION MEMORANDUM**CHRISTCHURCH**
CITY COUNCIL - ENVIRONMENT13
LIM No:
LIM70080262

- ◆ **Tree protected by City Plan (Notable) contained within this property**
This site contains a Heritage or Notable tree(s) listed in the City Plan and the tree(s) are protected by rules in the plan. If you are proposing to undertake any works within 10 metres of the tree(s) a resource consent is required and early consultation with council planning staff is recommended.
Species Name: Tilia x vulgaris Common Name: Common Lime
Crown Width(m)12 Height(m): 14
- ◆ **Tree protected by City Plan (Notable) contained within this property**
This site contains a Heritage or Notable tree(s) listed in the City Plan and the tree(s) are protected by rules in the plan. If you are proposing to undertake any works within 10 metres of the tree(s) a resource consent is required and early consultation with council planning staff is recommended.
Species Name: Tilia x vulgaris Common Name: Common Lime
Crown Width(m)12 Height(m): 14
- ◆ **Tree protected by City Plan (Notable) contained within this property**
This site contains a Heritage or Notable tree(s) listed in the City Plan and the tree(s) are protected by rules in the plan. If you are proposing to undertake any works within 10 metres of the tree(s) a resource consent is required and early consultation with council planning staff is recommended.
Species Name: Taxus baccata Fastigata Common Name: Irish Yew
Crown Width(m)9 Height(m): 10
- ◆ **Tree protected by City Plan (Notable) contained within this property**
This site contains a Heritage or Notable tree(s) listed in the City Plan and the tree(s) are protected by rules in the plan. If you are proposing to undertake any works within 10 metres of the tree(s) a resource consent is required and early consultation with council planning staff is recommended.
Species Name: Tilia x vulgaris Common Name: Common Lime
Crown Width(m)10 Height(m): 14
- ◆ **Tree protected by City Plan (Notable) contained within this property**
This site contains a Heritage or Notable tree(s) listed in the City Plan and the tree(s) are protected by rules in the plan. If you are proposing to undertake any works within 10 metres of the tree(s) a resource consent is required and early consultation with council planning staff is recommended.
Species Name: Tilia x vulgaris Common Name: Common Lime
Crown Width(m)11 Height(m): 15
- ◆ **Tree protected by City Plan (Notable) contained within this property**
This site contains a Heritage or Notable tree(s) listed in the City Plan and the tree(s) are protected by rules in the plan. If you are proposing to undertake any works within 10 metres of the tree(s) a resource consent is required and early consultation with council planning staff is recommended.
Species Name: Cedrus atlantica Common Name: Atlas Cedar
Crown Width(m)20 Height(m): 12
- ◆ **Tree protected by City Plan (Notable) contained within this property**
This site contains a Heritage or Notable tree(s) listed in the City Plan and the tree(s) are protected by rules in the plan. If you are proposing to undertake any works within 10 metres of the tree(s) a resource consent is required and early consultation with council planning staff is recommended.
Species Name: Juglans regia Common Name: Common Walnut
Crown Width(m)14 Height(m): 11

This Information was Processed at: Sockburn Service CentreCHRISTCHURCH CITY COUNCIL
P.O. BOX 237, CHRISTCHURCH

LAND INFORMATION MEMORANDUM



14
LIM No:
LIM70080262

- ◆ **Tree protected by City Plan (Notable) contained within this property**
This site contains a Heritage or Notable tree(s) listed in the City Plan and the tree(s) are protected by rules in the plan. If you are proposing to undertake any works within 10 metres of the tree(s) a resource consent is required and early consultation with council planning staff is recommended.
Species Name: Tilia x vulgaris Common Name: Common Lime
Crown Width(m)10 Height(m): 14

- ◆ **Tree protected by City Plan (Notable) contained within this property**
This site contains a Heritage or Notable tree(s) listed in the City Plan and the tree(s) are protected by rules in the plan. If you are proposing to undertake any works within 10 metres of the tree(s) a resource consent is required and early consultation with council planning staff is recommended.
Species Name: Tilia x vulgaris Common Name: Common Lime
Crown Width(m)11 Height(m): 12

- ◆ **Tree protected by City Plan (Notable) contained within this property**
This site contains a Heritage or Notable tree(s) listed in the City Plan and the tree(s) are protected by rules in the plan. If you are proposing to undertake any works within 10 metres of the tree(s) a resource consent is required and early consultation with council planning staff is recommended.
Species Name: Racosperma melanoxylon Common Name: Tasmanian Blackwood
Crown Width(m)10 Height(m): 10

- ◆ **Tree protected by City Plan (Notable) contained within this property**
This site contains a Heritage or Notable tree(s) listed in the City Plan and the tree(s) are protected by rules in the plan. If you are proposing to undertake any works within 10 metres of the tree(s) a resource consent is required and early consultation with council planning staff is recommended.
Species Name: Quercus robur Common Name: English Oak
Crown Width(m)15 Height(m): 15

- ◆ **Tree protected by City Plan (Notable) contained within this property**
This site contains a Heritage or Notable tree(s) listed in the City Plan and the tree(s) are protected by rules in the plan. If you are proposing to undertake any works within 10 metres of the tree(s) a resource consent is required and early consultation with council planning staff is recommended.
Species Name: Tilia x vulgaris Common Name: Common Lime
Crown Width(m)12 Height(m): 14

- ◆ **Tree protected by City Plan (Notable) contained within this property**
This site contains a Heritage or Notable tree(s) listed in the City Plan and the tree(s) are protected by rules in the plan. If you are proposing to undertake any works within 10 metres of the tree(s) a resource consent is required and early consultation with council planning staff is recommended.
Species Name: Platanus x accrifolia Common Name: London Plane
Crown Width(m)20 Height(m): 15

- ◆ **Tree protected by City Plan (Notable) contained within this property**
This site contains a Heritage or Notable tree(s) listed in the City Plan and the tree(s) are protected by rules in the plan. If you are proposing to undertake any works within 10 metres of the tree(s) a resource consent is required and early consultation with council planning staff is recommended.
Species Name: Thuja plicata Common Name: Western Red Cedar
Crown Width(m)15 Height(m): 17

This Information was Processed at: Sockburn Service Centre

LAND INFORMATION MEMORANDUM



15
LIM No:
LIM70080262

- ◆ **Tree protected by City Plan (Notable) contained within this property**
This site contains a Heritage or Notable tree(s) listed in the City Plan and the tree(s) are protected by rules in the plan. If you are proposing to undertake any works within 10 metres of the tree(s) a resource consent is required and early consultation with council planning staff is recommended.
Species Name: Taxus baccata Fastigata Common Name: Irish Yew
Crown Width(m)9 Height(m): 9
- ◆ **Tree protected by City Plan (Notable) contained within this property**
This site contains a Heritage or Notable tree(s) listed in the City Plan and the tree(s) are protected by rules in the plan. If you are proposing to undertake any works within 10 metres of the tree(s) a resource consent is required and early consultation with council planning staff is recommended.
Species Name: Quercus carris Common Name: Turkey Oak
Crown Width(m)22 Height(m): 21
- ◆ **Tree protected by City Plan (Notable) contained within this property**
This site contains a Heritage or Notable tree(s) listed in the City Plan and the tree(s) are protected by rules in the plan. If you are proposing to undertake any works within 10 metres of the tree(s) a resource consent is required and early consultation with council planning staff is recommended.
Species Name: Tilia x vulgaris Common Name: Common Lime
Crown Width(m)10 Height(m): 14
- ◆ **Tree protected by City Plan (Notable) contained within this property**
This site contains a Heritage or Notable tree(s) listed in the City Plan and the tree(s) are protected by rules in the plan. If you are proposing to undertake any works within 10 metres of the tree(s) a resource consent is required and early consultation with council planning staff is recommended.
Species Name: Tilia x vulgaris Common Name: Common Lime
Crown Width(m)11 Height(m): 14
- ◆ **Tree protected by City Plan (Notable) contained within this property**
This site contains a Heritage or Notable tree(s) listed in the City Plan and the tree(s) are protected by rules in the plan. If you are proposing to undertake any works within 10 metres of the tree(s) a resource consent is required and early consultation with council planning staff is recommended.
Species Name: Chamaecyparis lawsoniana Common Name: Lawson Cypress
Crown Width(m)11 Height(m): 17
- ◆ **Tree protected by City Plan (Notable) contained within this property**
This site contains a Heritage or Notable tree(s) listed in the City Plan and the tree(s) are protected by rules in the plan. If you are proposing to undertake any works within 10 metres of the tree(s) a resource consent is required and early consultation with council planning staff is recommended.
Species Name: Tilia x vulgaris Common Name: Common Lime
Crown Width(m)11 Height(m): 13
- ◆ **Tree protected by City Plan (Notable) contained within this property**
This site contains a Heritage or Notable tree(s) listed in the City Plan and the tree(s) are protected by rules in the plan. If you are proposing to undertake any works within 10 metres of the tree(s) a resource consent is required and early consultation with council planning staff is recommended.
Species Name: Quercus robur Common Name: English Oak
Crown Width(m)15 Height(m): 17

This Information was Processed at: **Sockburn Service Centre**

CHRISTCHURCH CITY COUNCIL
P.O. BOX 237, CHRISTCHURCH

LAND INFORMATION MEMORANDUM16
LIM No:
LIM70080262

- ◆ **Tree protected by City Plan (Notable) contained within this property**
This site contains a Heritage or Notable tree(s) listed in the City Plan and the tree(s) are protected by rules in the plan. If you are proposing to undertake any works within 10 metres of the tree(s) a resource consent is required and early consultation with council planning staff is recommended.
Species Name: Araucaria araucana Common Name: Monkey Puzzle
Crown Width(m)11 Height(m): 17

- ◆ **Tree protected by City Plan (Notable) contained within this property**
This site contains a Heritage or Notable tree(s) listed in the City Plan and the tree(s) are protected by rules in the plan. If you are proposing to undertake any works within 10 metres of the tree(s) a resource consent is required and early consultation with council planning staff is recommended.
Species Name: Chamaecyparis pisifera Common Name: Sawara Cypress
Crown Width(m)6 Height(m): 11

- ◆ **Tree protected by City Plan (Notable) contained within this property**
This site contains a Heritage or Notable tree(s) listed in the City Plan and the tree(s) are protected by rules in the plan. If you are proposing to undertake any works within 10 metres of the tree(s) a resource consent is required and early consultation with council planning staff is recommended.
Species Name: Araucaria araucana Common Name: Monkey Puzzle
Crown Width(m)10 Height(m): 16

- ◆ **Tree protected by City Plan (Notable) contained within this property**
This site contains a Heritage or Notable tree(s) listed in the City Plan and the tree(s) are protected by rules in the plan. If you are proposing to undertake any works within 10 metres of the tree(s) a resource consent is required and early consultation with council planning staff is recommended.
Species Name: Chamaecyparis lawsoniana Common Name: Lawson Cypress
Crown Width(m)14 Height(m): 19

- ◆ **Tree protected by City Plan (Notable) contained within this property**
This site contains a Heritage or Notable tree(s) listed in the City Plan and the tree(s) are protected by rules in the plan. If you are proposing to undertake any works within 10 metres of the tree(s) a resource consent is required and early consultation with council planning staff is recommended.
Species Name: Quercus cerris Common Name: Turkey Oak
Crown Width(m)22 Height(m): 21

- ◆ **Tree protected by City Plan (Notable) contained within this property**
This site contains a Heritage or Notable tree(s) listed in the City Plan and the tree(s) are protected by rules in the plan. If you are proposing to undertake any works within 10 metres of the tree(s) a resource consent is required and early consultation with council planning staff is recommended.
Species Name: Magnolia grandiflora Common Name: Southern Magnolia
Crown Width(m)12 Height(m): 10

- ◆ **Tree protected by City Plan (Notable) contained within this property**
This site contains a Heritage or Notable tree(s) listed in the City Plan and the tree(s) are protected by rules in the plan. If you are proposing to undertake any works within 10 metres of the tree(s) a resource consent is required and early consultation with council planning staff is recommended.
Species Name: Quercus cerris Common Name: Turkey Oak
Crown Width(m)28 Height(m): 18

This Information was Processed at: **Sockburn Service Centre**

CHRISTCHURCH CITY COUNCIL
P.O. BOX 237, CHRISTCHURCH

LAND INFORMATION MEMORANDUM17
LIM No:
LIM70080262

- ◆ **Tree protected by City Plan (Notable) within 10m of this property**
This site is affected by a 10 metre setback rule from a Heritage or Notable tree(s) listed in the City Plan at 1 LINCOLN ROAD The tree(s) are protected by rules in the plan. If you are proposing to undertake any works within 10 metres of the tree(s) a resource consent is required and early consultation with council planning staff is recommended.

- ◆ **Tree protected by City Plan (Notable) within 10m of this property**
This site is affected by a 10 metre setback rule from a Heritage or Notable tree(s) listed in the City Plan at 65 SYLVAN STREET The tree(s) are protected by rules in the plan. If you are proposing to undertake any works within 10 metres of the tree(s) a resource consent is required and early consultation with council planning staff is recommended.

- ◆ **Tree protected by City Plan (Notable) within 10m of this property**
This site is affected by a 10 metre setback rule from a Heritage or Notable tree(s) listed in the City Plan at 1 LINCOLN ROAD The tree(s) are protected by rules in the plan. If you are proposing to undertake any works within 10 metres of the tree(s) a resource consent is required and early consultation with council planning staff is recommended.

- ◆ **Tree protected by City Plan (Notable) within 10m of this property**
This site is affected by a 10 metre setback rule from a Heritage or Notable tree(s) listed in the City Plan at 1 LINCOLN ROAD The tree(s) are protected by rules in the plan. If you are proposing to undertake any works within 10 metres of the tree(s) a resource consent is required and early consultation with council planning staff is recommended.

- ◆ **Tree protected by City Plan (Notable) within 10m of this property**
This site is affected by a 10 metre setback rule from a Heritage or Notable tree(s) listed in the City Plan at 1 LINCOLN ROAD The tree(s) are protected by rules in the plan. If you are proposing to undertake any works within 10 metres of the tree(s) a resource consent is required and early consultation with council planning staff is recommended.

- ◆ **Tree protected by City Plan (Notable) within 10m of this property**
This site is affected by a 10 metre setback rule from a Heritage or Notable tree(s) listed in the City Plan at 1 LINCOLN ROAD The tree(s) are protected by rules in the plan. If you are proposing to undertake any works within 10 metres of the tree(s) a resource consent is required and early consultation with council planning staff is recommended.

- ◆ **Tree protected by City Plan (Notable) within 10m of this property**
This site is affected by a 10 metre setback rule from a Heritage or Notable tree(s) listed in the City Plan at 1 LINCOLN ROAD The tree(s) are protected by rules in the plan. If you are proposing to undertake any works within 10 metres of the tree(s) a resource consent is required and early consultation with council planning staff is recommended.

This Information was Processed at: **Sockburn Service Centre**

CHRISTCHURCH CITY COUNCIL
P.O. BOX 237, CHRISTCHURCH

LAND INFORMATION MEMORANDUM



CHRISTCHURCH
CITY COUNCIL - ENVIRONMENT

18

LIM No:
LIM70080262

- ◆ **Tree protected by City Plan (Notable) within 10m of this property**
This site is affected by a 10 metre setback rule from a Heritage or Notable tree(s) listed in the City Plan at 1 LINCOLN ROAD The tree(s) are protected by rules in the plan. If you are proposing to undertake any works within 10 metres of the tree(s) a resource consent is required and early consultation with council planning staff is recommended.
- ◆ **Tree protected by City Plan (Notable) within 10m of this property**
This site is affected by a 10 metre setback rule from a Heritage or Notable tree(s) listed in the City Plan at 1 LINCOLN ROAD The tree(s) are protected by rules in the plan. If you are proposing to undertake any works within 10 metres of the tree(s) a resource consent is required and early consultation with council planning staff is recommended.
- ◆ **Tree protected by City Plan (Notable) within 10m of this property**
This site is affected by a 10 metre setback rule from a Heritage or Notable tree(s) listed in the City Plan at 1 LINCOLN ROAD The tree(s) are protected by rules in the plan. If you are proposing to undertake any works within 10 metres of the tree(s) a resource consent is required and early consultation with council planning staff is recommended.
- ◆ **Tree protected by Subdivision Consent contained within this property**
This site contains a tree which was required by a condition of subdivision. This tree is protected. If you are propose to remove the tree, the agreement of council is required and early consultation with council subdivision staff is recommended. Species Name: *Betula pendula*
Common Name: Silver Birch Crown Width(m): 15
Height(m): 11
- ◆ **Tree protected by Subdivision Consent contained within this property**
This site contains a tree which was required by a condition of subdivision. This tree is protected. If you are propose to remove the tree, the agreement of council is required and early consultation with council subdivision staff is recommended. Species Name: *Liquidambar styraciflua*
Common Name: Sweet Gum Crown Width(m): 10
Height(m): 13
- ◆ **Tree protected by Subdivision Consent contained within this property**
This site contains a tree which was required by a condition of subdivision. This tree is protected. If you are propose to remove the tree, the agreement of council is required and early consultation with council subdivision staff is recommended. Species Name: *Quercus palustris*
Common Name: Pin Oak Crown Width(m): 17
Height(m): 14
- ◆ **Tree protected by Subdivision Consent contained within this property**
This site contains a tree which was required by a condition of subdivision. This tree is protected. If you are propose to remove the tree, the agreement of council is required and early consultation with council subdivision staff is recommended. Species Name: *Pterocarya x rehderana*
Common Name: Hybrid Wingnut Crown Width(m): 9
Height(m): 11

This Information was Processed at: Sockburn Service Centre

CHRISTCHURCH CITY COUNCIL
P.O. BOX 237, CHRISTCHURCH

LAND INFORMATION MEMORANDUM



19
LIM No:
LIM70080262

- ◆ **Tree protected by Subdivision Consent contained within this property**
This site contains a tree which was required by a condition of subdivision. This tree is protected. If you are propose to remove the tree, the agreement of council is required and early consultation with council subdivision staff is recommended. Species Name: Ulmus glabra Lutescens
Common Name: Golden Elm Crown Width(m): 10
Height(m): 7
- ◆ **Tree protected by Subdivision Consent contained within this property**
This site contains a tree which was required by a condition of subdivision. This tree is protected. If you are propose to remove the tree, the agreement of council is required and early consultation with council subdivision staff is recommended. Species Name: Quercus coccinea
Common Name: Scarlet Oak Crown Width(m): 11
Height(m): 8
- ◆ **Tree protected by Subdivision Consent contained within this property**
This site contains a tree which was required by a condition of subdivision. This tree is protected. If you are propose to remove the tree, the agreement of council is required and early consultation with council subdivision staff is recommended. Species Name: Ulmus glabra Lutescens
Common Name: Golden Elm Crown Width(m): 10
Height(m): 7
- ◆ **Tree protected by Subdivision Consent contained within this property**
This site contains a tree which was required by a condition of subdivision. This tree is protected. If you are propose to remove the tree, the agreement of council is required and early consultation with council subdivision staff is recommended. Species Name: Betula pendula
Common Name: Silver Birch Crown Width(m): 16
Height(m): 16
- ◆ **Tree protected by Subdivision Consent contained within this property**
This site contains a tree which was required by a condition of subdivision. This tree is protected. If you are propose to remove the tree, the agreement of council is required and early consultation with council subdivision staff is recommended. Species Name: Fagus sylvatica
Common Name: European Beech Crown Width(m): 10
Height(m): 7
- ◆ **Tree protected by Subdivision Consent contained within this property**
This site contains a tree which was required by a condition of subdivision. This tree is protected. If you are propose to remove the tree, the agreement of council is required and early consultation with council subdivision staff is recommended. Species Name: Fagus sylvatica Purpurea
Common Name: Copper Beech Crown Width(m): 11
Height(m): 13
- ◆ **Tree protected by Subdivision Consent contained within this property**
This site contains a tree which was required by a condition of subdivision. This tree is protected. If you are propose to remove the tree, the agreement of council is required and early consultation with council subdivision staff is recommended. Species Name: Liriodendron tulipifera
Common Name: Tulip Tree Crown Width(m): 13
Height(m): 17

This Information was Processed at: **Sockburn Service Centre**

LAND INFORMATION MEMORANDUM
CHRISTCHURCH
 CITY COUNCIL - GOVERNMENT

20

 LIM No:
 LIM70080262

- ◆ **Tree protected by Subdivision Consent contained within this property**
 This site contains a tree which was required by a condition of subdivision. This tree is protected. If you are propose to remove the tree, the agreement of council is required and early consultation with council subdivision staff is recommended. Species Name: Castanea sativa
 Common Name: Sweet Chestnut Crown Width(m): 12
 Height(m): 9

- ◆ **Tree protected by Subdivision Consent contained within this property**
 This site contains a tree which was required by a condition of subdivision. This tree is protected. If you are propose to remove the tree, the agreement of council is required and early consultation with council subdivision staff is recommended. Species Name: Quercus canariensis
 Common Name: Algerian Oak Crown Width(m): 13
 Height(m): 13

10. Water Related Property Information

- ◆ Borelog/Engineer Report Image Available

11. Special Site Characteristics and Additional Water Related Services Information

- ◆ A drainage plan is attached. For further enquiries regarding drainage information supplied with the LIM please phone 941 8869.
- ◆ The drainage works associated with this property have not been plotted on the Council's drainage plan. A copy of the field Inspectors pickup showing the drains and house outline is attached.
- ◆ Sewer and stormwater connections have been installed to serve this lot, as part of the subdivision development.
- ◆ The records held by this Unit do not show any history of flooding or drainage problems on the property.

Please Note :

The Council may require a development contribution in respect of any activities in the City that create a demand for new reserves and infrastructure. Such activities include sub-division of land parcels and new construction. The Development Contributions Policy and supporting information is obtainable online at <http://www.ccc.govt.nz/LTCCP/Draft/DevelopmentContributionsPolicy/> and at Civic Offices, Tuam Street and Council Service Centres

To enable Council to measure the accuracy of this LIM document based on our current records, we would appreciate your response should you find any information contained therein which may be considered to be incorrect or omitted. Please telephone the appropriate Service Centre as shown on the front page of this LIM.

This Information was Processed at: **Sockburn Service Centre**

CHRISTCHURCH CITY COUNCIL
 P.O. BOX 237, CHRISTCHURCH

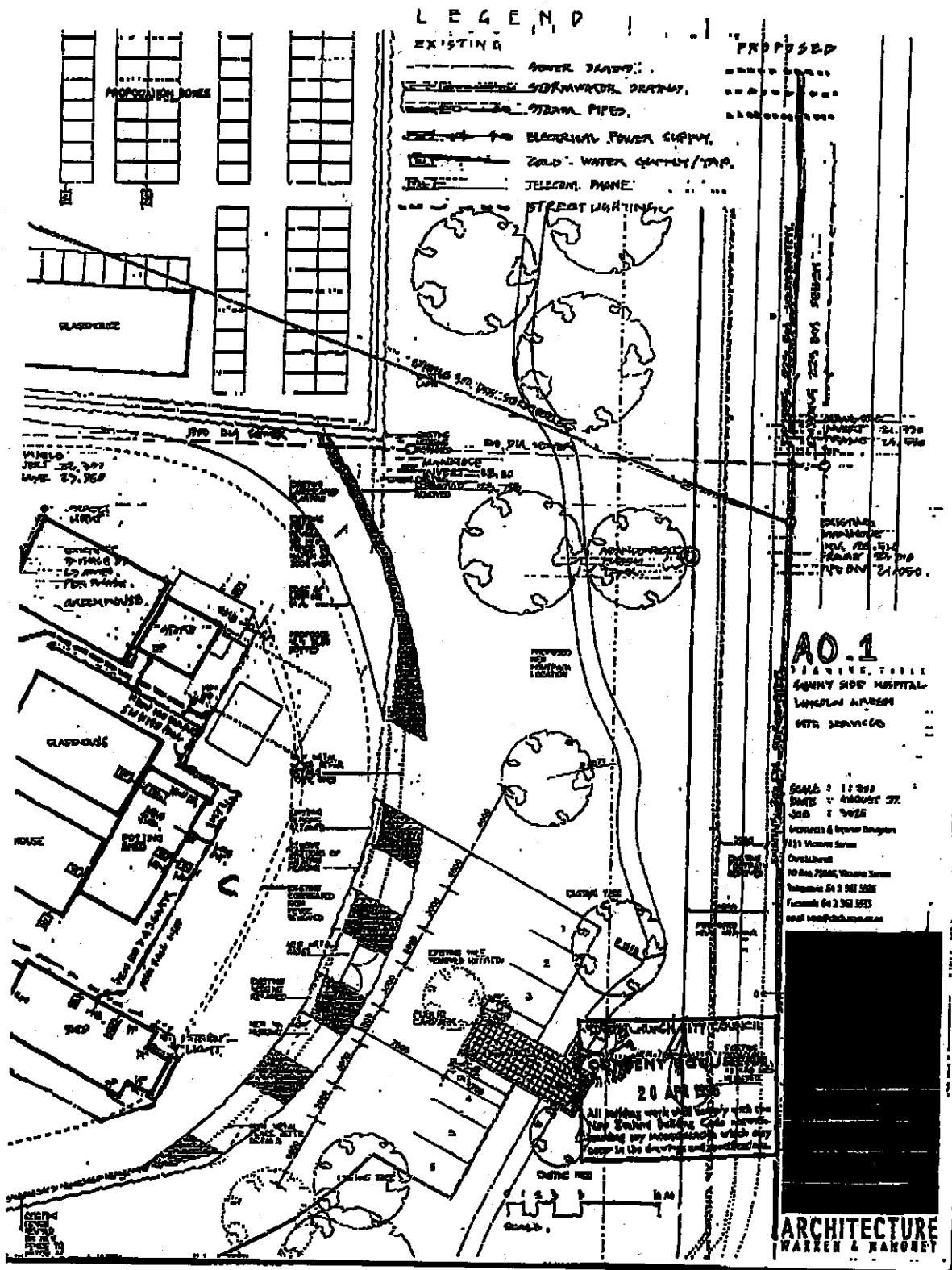

		ADDRESS / LINCOLN	
REG. DESCRIPTION		OWNER	
PROJECT No. 98004371		P. PIRNAY	
DATE: 14.6.77		STARRS	
FIELD OFFICER		RECEIVED:	
(Signature)		RECEIVED:	
(Signature)		RECORDED:	
(Signature)		INDEXED:	
(Signature)		FILED:	
(Signature)		(Signature)	
(Signature)		(Signature)	
(Signature)		(Signature)	
(Signature)		(Signature)	
(Signature)		(Signature)	
(Signature)		(Signature)	
(Signature)		(Signature)	
(Signature)		(Signature)	
(Signature)		(Signature)	
(Signature)		(Signature)	
(Signature)		(Signature)	
(Signature)		(Signature)	
(Signature)		(Signature)	
(Signature)		(Signature)	
(Signature)		(Signature)	
(Signature)		(Signature)	
(Signature)		(Signature)	
(Signature)		(Signature)	
(Signature)		(Signature)	
(Signature)		(Signature)	
(Signature)		(Signature)	
(Signature)		(Signature)	
(Signature)		(Signature)	
(Signature)		(Signature)	
(Signature)		(Signature)	
(Signature)		(Signature)	
(Signature)		(Signature) 4</tr	

CHRISTCHURCH CITY COUNCIL - DRAINAGE PICK UP

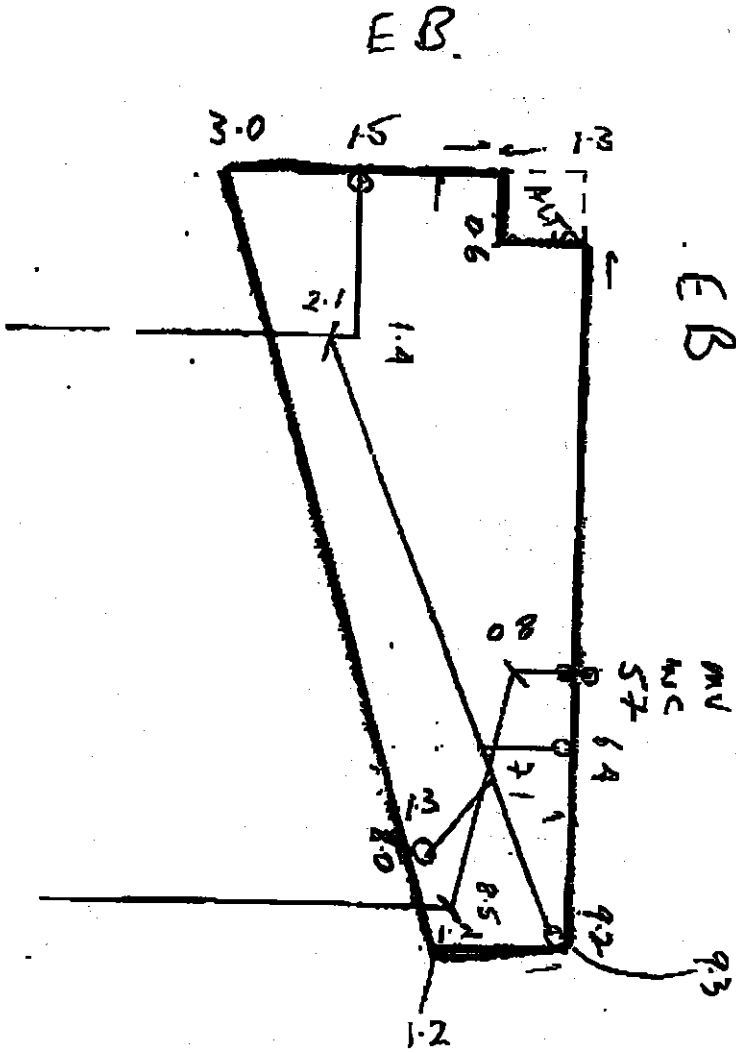

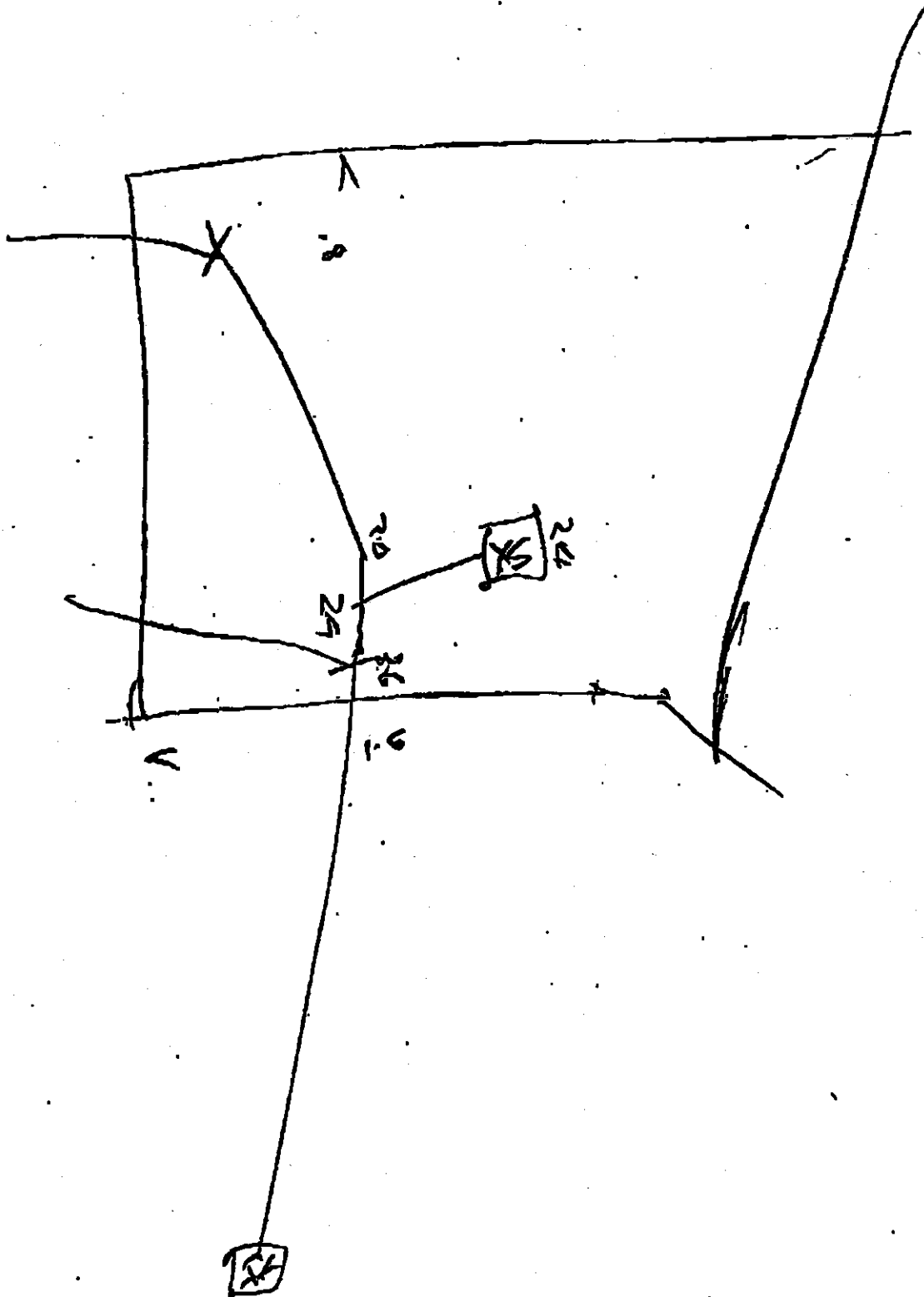

	ADDRESS: <i>1 Riverside</i> LEGAL DESCRIPTION: <i>9100 4333</i> PROJECT No.: <i>9100 4333</i> DATE: <i>9.6.07</i>	OWNER: <i>S. Haddock</i> DRAIN/LAYER: <i>S. Haddock</i> RUNNER: <i>W. S. S. S. S.</i> FIELD OFFICER: <i>Alison Hurney</i>	RECORD: <i>29 DEC 1998</i> PROGRAM: <i>HH 74</i> HOTTER: <i>1</i> PEBROCK: <i>1</i>	CONNECTION NUMBER: <i>74</i>
	# <i>11803</i>	W/M <i>11803</i>		

CHRISTCHURCH CITY COUNCIL - DRAINAGE PICK UP

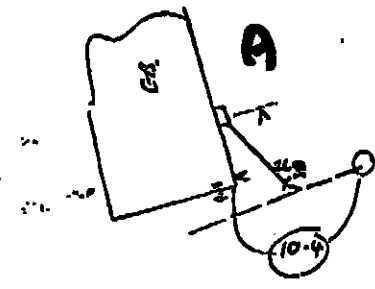

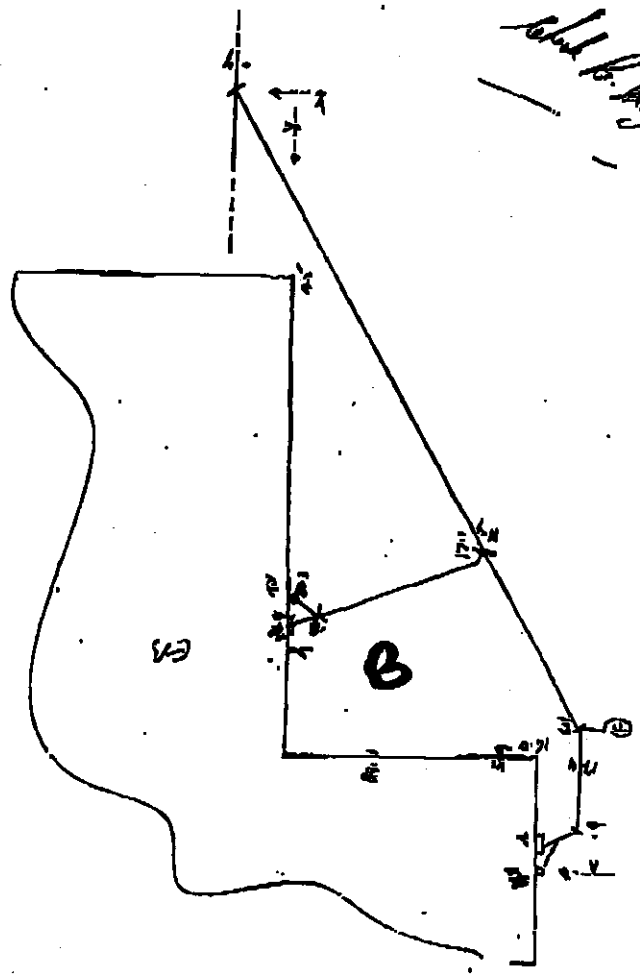

John B. Hogg

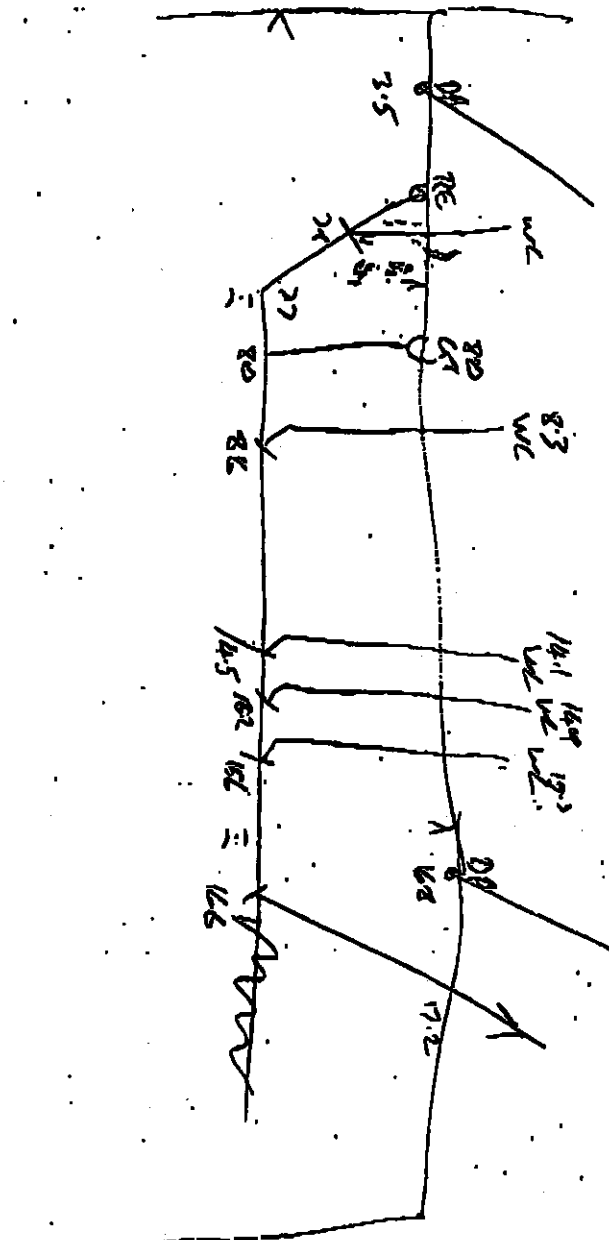

11D-02

		CHRISTCHURCH CITY COUNCIL - DRAINAGE PICK UP	
ADDRESS: 121/24 LEGAL DESCRIPTION: PROJECT No.: 6-7-24 DATE:		OWNER: DRAWN BY: [Signature] PLANNER: FIELD OFFICER:	
RECEIVED: BOOK/PLAN: NOTED: / EYE BOOK:		CONNECTION NUMBER:	



		CHESBURN CITY COUNCIL - RANGE NO. 10	
ADDRESS: <i>1 Dundee</i> LEGAL DESCRIPTION: PROJECT No.: <i>91002333</i> DATE: <i>1.7.98</i>	OWNER: DRAWN BY: <i>R. McNeil</i> PLUMBER: FIELD OFFICER: <i>Alan Hurry</i>	RECORDED: <i>24 DEC 1998</i> REVISION: <i>HHV</i> ROTTEN: EYEBOOK:	CONNECTION NUMBER: <i>74</i>

*16816

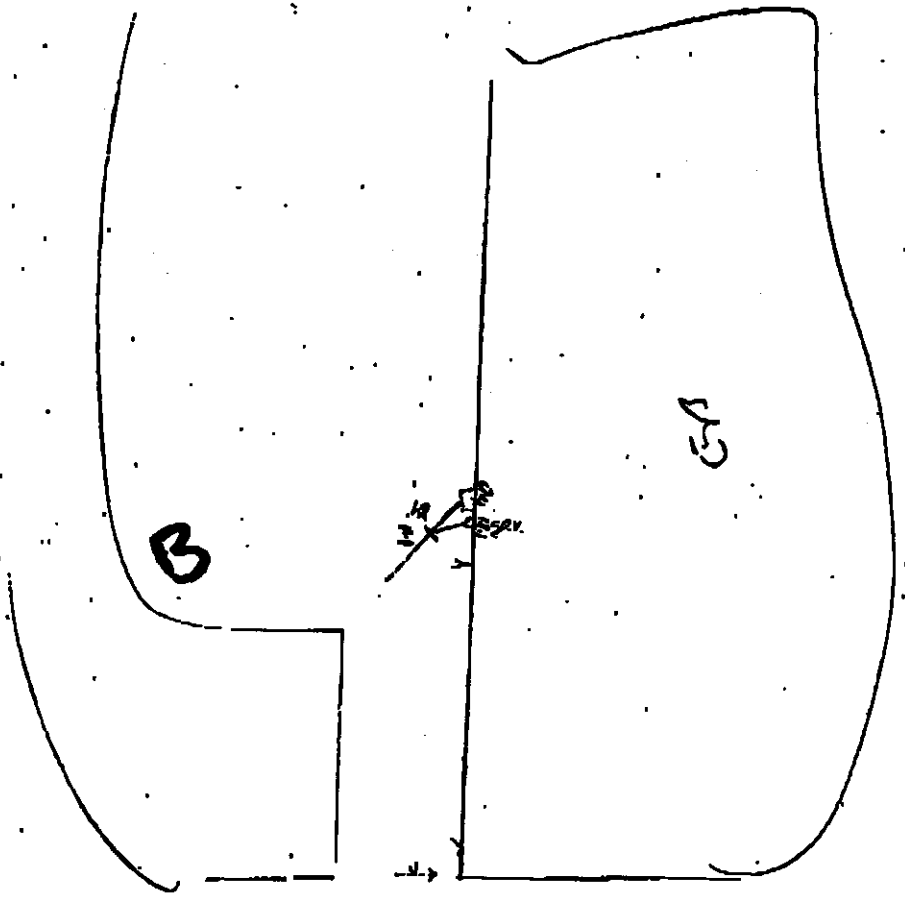

110-02

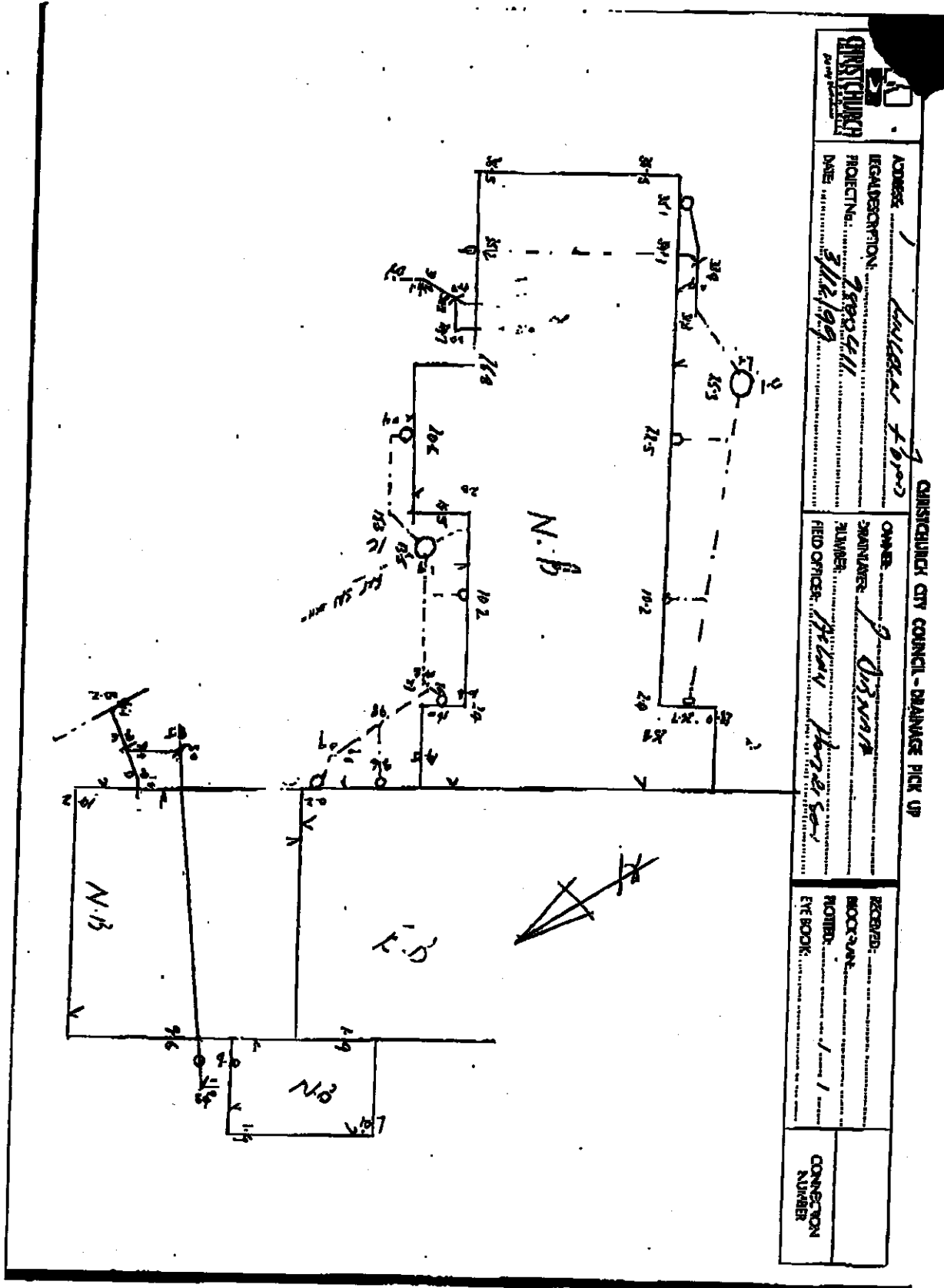

ADDRESS: <i>Latimer St 16003</i>	
LEGAL DESCRIPTION: <i>7993/411</i>	
PROJECT No.: <i>312/99</i>	
DATE:	
OWNER: <i>Christchurch City Council</i>	
DRAWN BY: <i>D. D. D.</i>	
FIELD OFFICER: <i>Michael Parsons</i>	
RECORD:	
BOOK No.:	
NOTED:	
EYE BOOK:	
CONNECTION NUMBER:	

CHRISTCHURCH CITY COUNCIL - DRAINAGE PICK UP

	
ADDRESS: <i>1 Avenue St</i> LEGAL DESCRIPTION: <i>1100/553</i> PROJECT No.: <i>17-c-98</i>	
OWNER: DRAINAGE RUNNER: <i>Alex T. T. T.</i> FED OFFICER: <i>Alan Harvey</i>	RECEIVED: BOOKMAN: ROTTED: BY BOOK:
CHRISTCHURCH CITY COUNCIL - DRAINAGE PICK UP	
CONNECTION NUMBER	

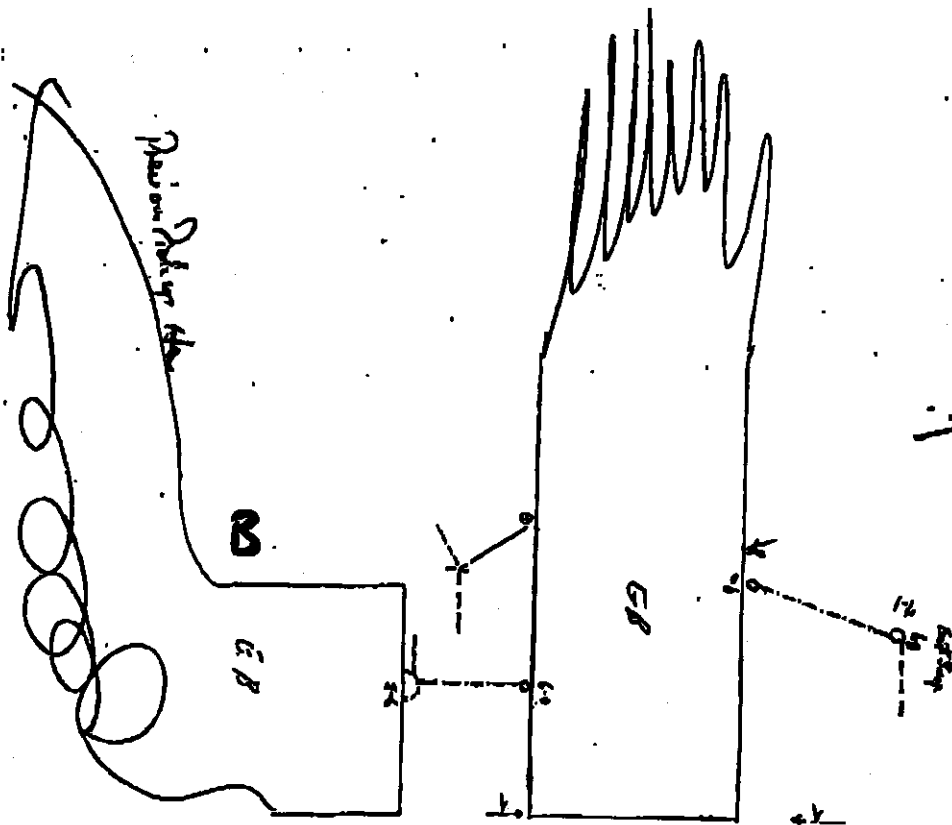

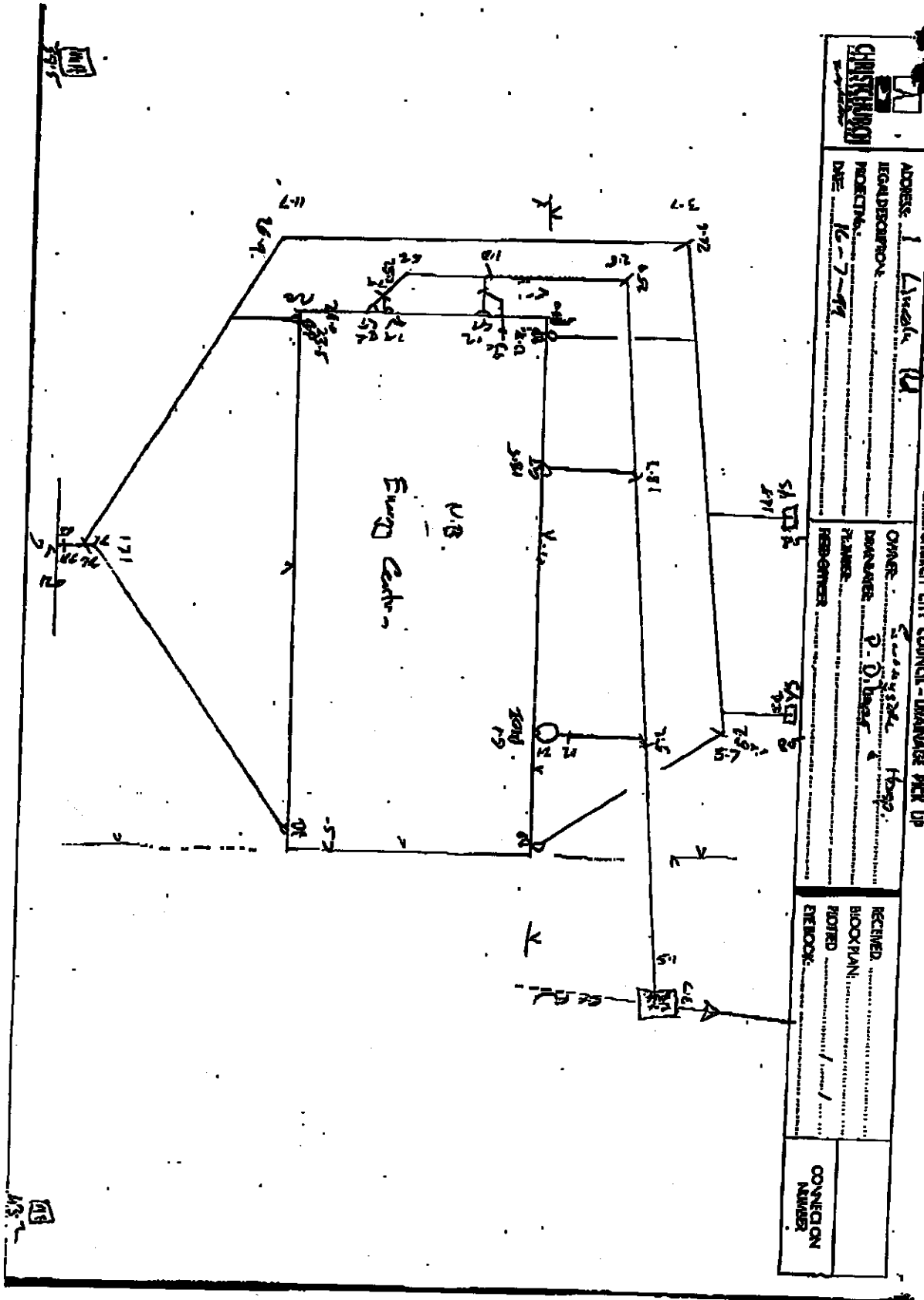

ADDRESS: <u>1 Lincoln Rd.</u> LEGAL DESCRIPTION: PROJECT NO.: DATE: <u>16-7-99</u>	CHURCH CITY COUNCIL - DRAINAGE PICK UP OWNER: <u>Lincoln Rd. Prop.</u> DRAWN BY: <u>P. O'Leary</u> REVISIONS:
RECEIVED: BLOCK PLAN: NOTED: REFERENCE:	CONNECTION NUMBER:



	
ADDRESS: <i>1 Acklands</i> LEGAL DESCRIPTION: <i>9802553</i> PROJECT No.: <i>17-c-12</i> DATE:	CHURCHILL CITY COUNCIL - DRAINAGE PICK UP
OWNER: <i>Christchurch City Council</i> DRAINAGE MANAGER: <i>John Hogg</i> FIELD OFFICER: <i>Allen Hickey</i>	RECEIVED: <i>17/1/07</i> BLOCK PLAN: <i>17/1/07</i> PLOTTED: <i>17/1/07</i> FENBOOK:
CONNECTION NUMBER:	

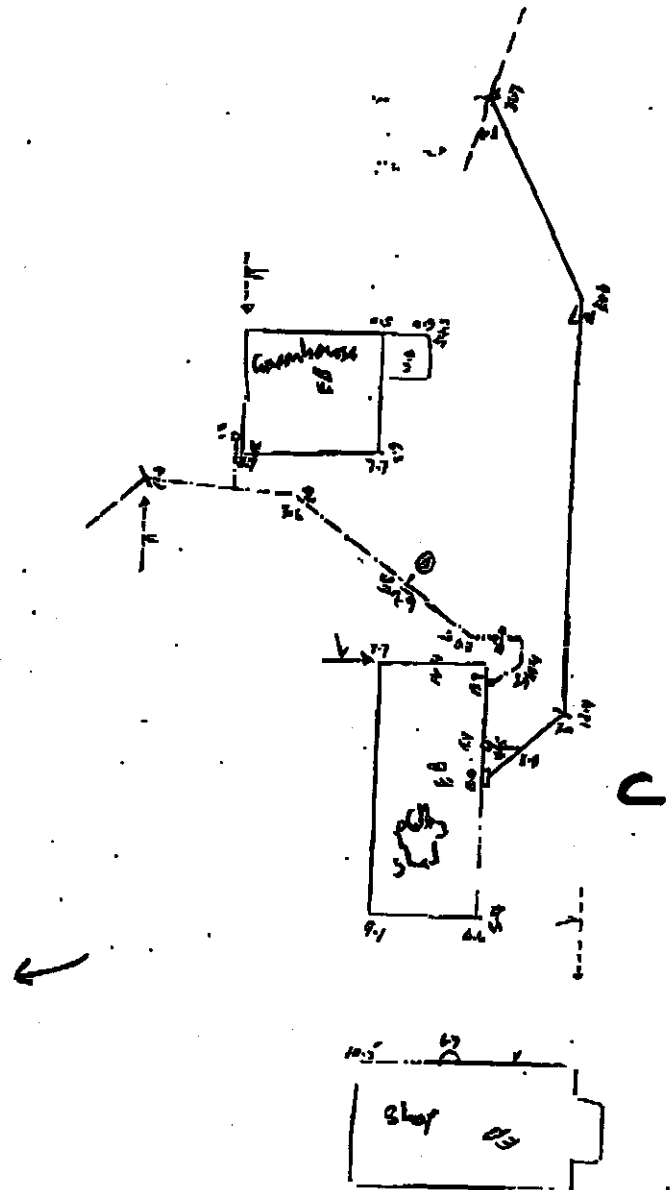

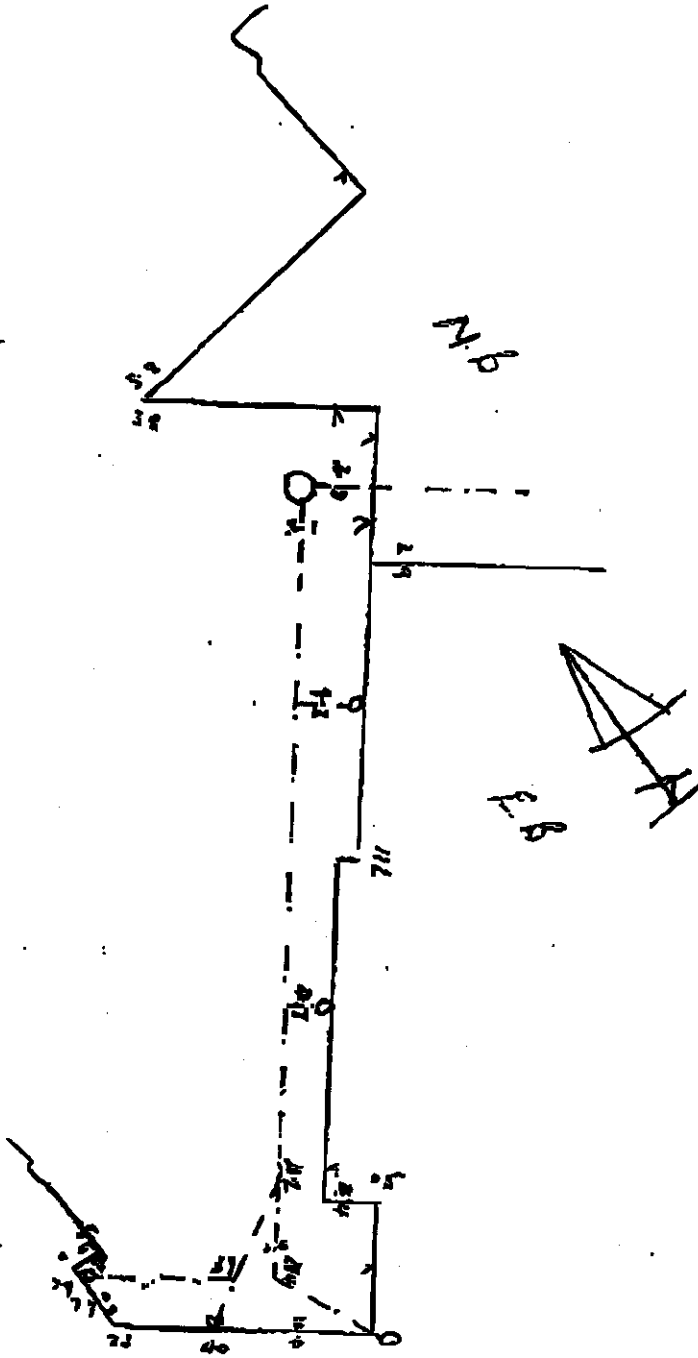

26101

CHRISTCHURCH CITY COUNCIL - DRAINAGE PICK UP

<p>ADDRESS: <i>Lincoln Road</i></p> <p>SOIL DESCRIPTION: <i>9900 6571</i></p> <p>PROJECT NO.: <i>775797</i></p> <p>DATE: <i>02/01/07</i></p>	<p>CHASSIS: <i>1</i></p> <p>DRAWN BY: <i>S. S. S. S.</i></p> <p>NUMBER: <i>1</i></p> <p>FEED OFFICE: <i>1</i></p>	<p>RECEIVED:</p> <p>BOOK PLAN:</p> <p>NOTED:</p> <p>FILED:</p>	<p>CONNECTION NUMBER:</p>
--	---	--	----------------------------------

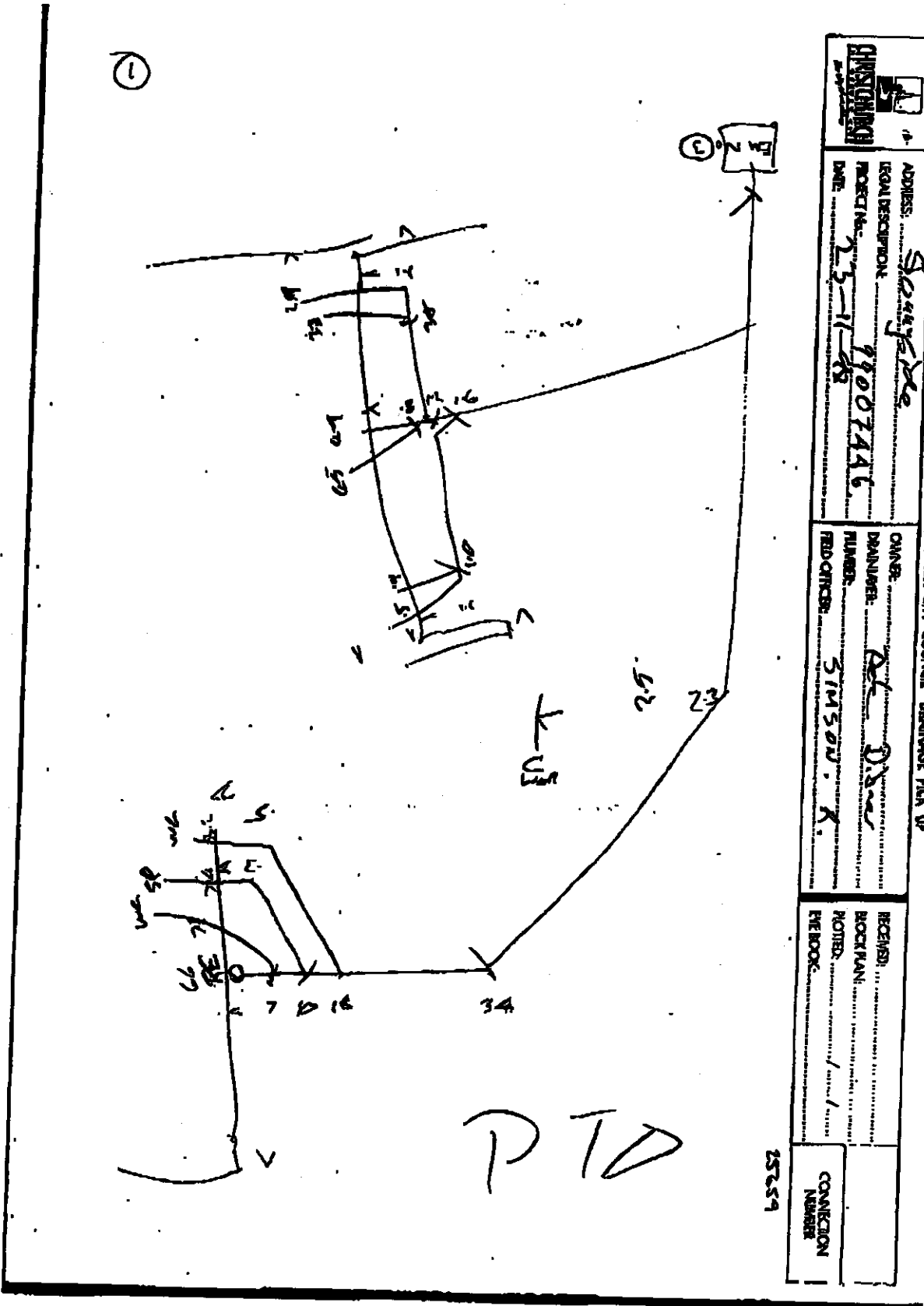

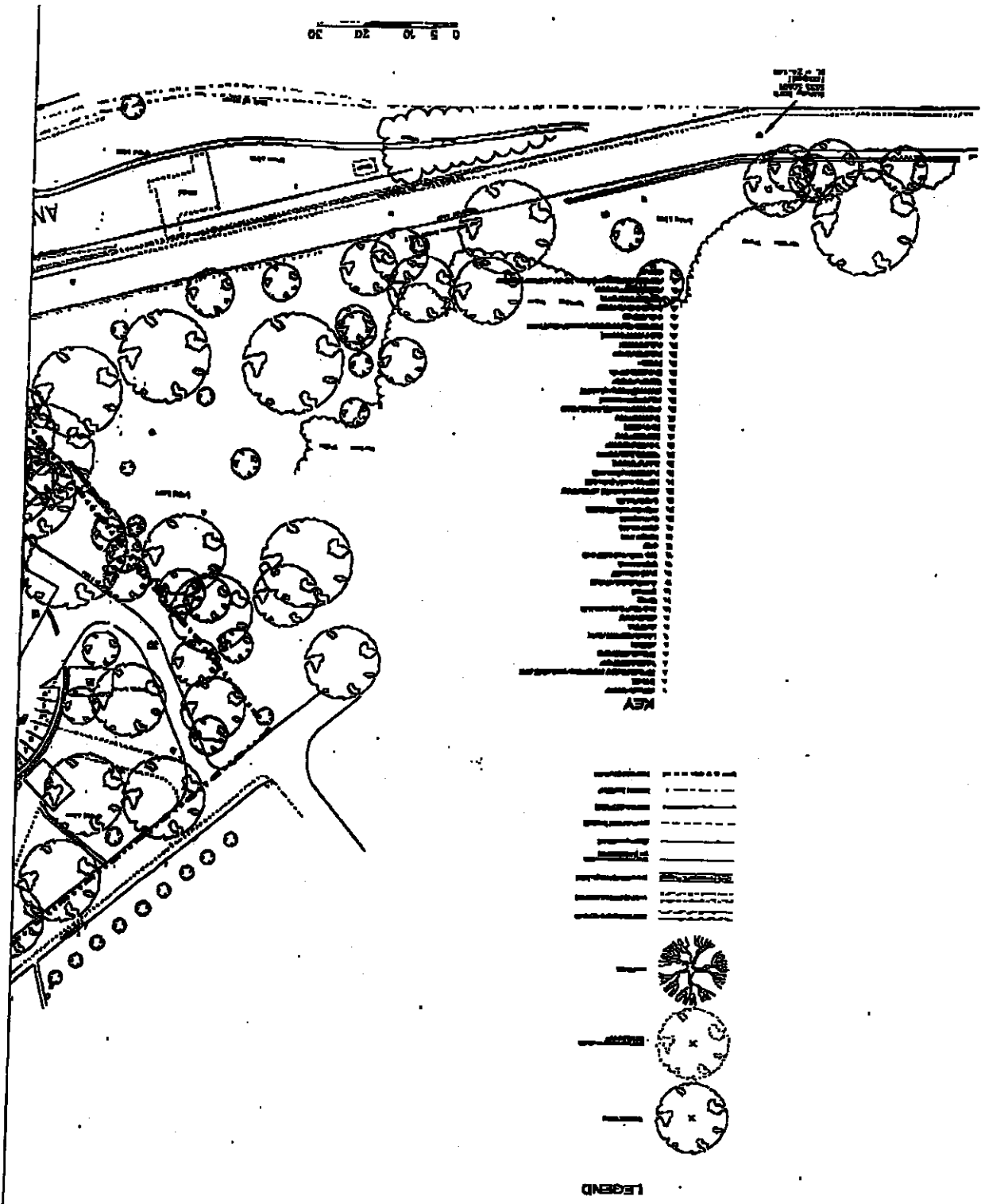

		1 LINCOLN RD CHRISTCHURCH CITY COUNCIL - DRAINAGE PICK UP	
ADDRESS: <i>Sony's</i> LOCAL DESCRIPTION: <i>9907446</i> PROJECT NO.: <i>23-11-88</i> DATE:	DRAWN BY: <i>A. D. S.</i> CHECKED BY: <i>S. SIMSON, K.</i> RIDGECORP:	RECEIVED: _____ ROCK PLAN: _____ POTTER: _____ THE BOOK: _____	CONNECTION NUMBER: 25259

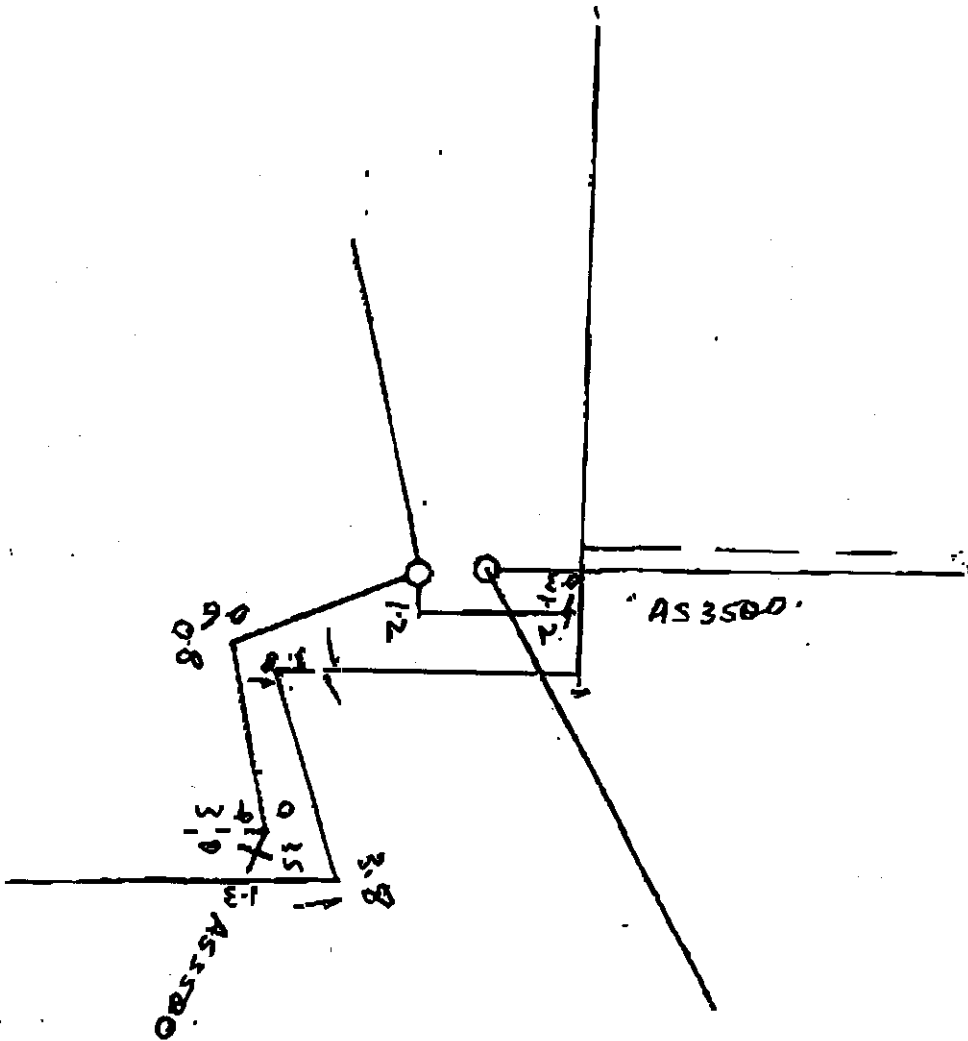

	
ADDRESS: <u>1 LINCOLN</u> ROAD/SECTION: <u>98004571</u> DATE: <u>18.2.99</u>	CHARGE: <u>P 018744</u> DRAWING NUMBER: <u>CLYDE & RYAN</u> FIELD OFFICER: <u>SI 1585</u>
RECEIVED: _____ BY: _____ NAME: _____ SERVICE: _____	CONNECTION NUMBER: _____

CHARGED BY COUNCIL - DRAWING PER OF



		CHESHIRE EAST COUNCIL - DRAINAGE PICK UP	
ADDRESS: 32 ROAD DESCRIPTION: F. JAMES ST. PROJECT NUMBER: 10040681 DATE: 25/3/07	OWNER: R. ALPHE DEAN AVE: 1 NUMBER: 1 REC OFFICER: STUBBS	RECORDS: SECTION: 1 TIGHT: 1 WEARBOX: 1	CONNECTION MAINS:

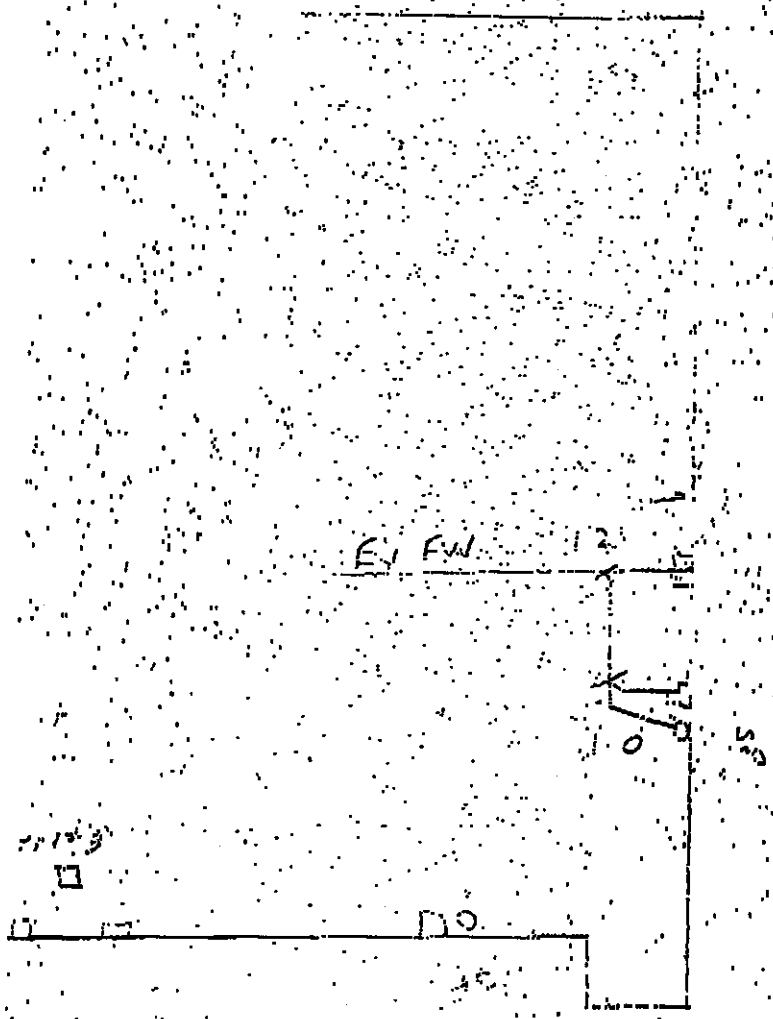



CHRISTCHURCH
CITY COUNCIL · ENVIRONMENT

23 January 2004

KiwiKids Preschool Ltd
C/- Kate Askew
Boffa Miskell Limited
P O Box 110
CHRISTCHURCH

Dear Madam,

RESOURCE MANAGEMENT ACT 1991
APPLICATION FOR RESOURCE CONSENT RMA 20015287
32 ANNEX ROAD

I refer to your application for land use consent to establish and operate a preschool.

The Resource Management Officer Committee has considered this application on a non-notified basis pursuant to Sections 93 and 94 of the Resource Management Act and consent has been granted subject to 6 conditions. A copy of the decision is enclosed for your information.

It should be emphasised that to ensure that you comply with this Resource Consent all conditions of consent must be complied with and the consent holder must continue to comply with all conditions in order that the activity remains lawfully established.

Attached is an invoice for additional fees incurred in the processing of this application. Please ensure that payment is made on or before 20th February 2004 at any Council office.

A copy of this Resource Consent will be forwarded to the Building Consent Team who will notify you when your Building Consent is ready for issue.

Yours faithfully

John Higgins
PLANNER
AREA DEVELOPMENT TEAM - SOCKBURN

cc Building, David Hutt
Monitoring, Grant Cousens

ADDITIONAL INFORMATION RELATING TO THE GRANTING OF NON-NOTIFIED RESOURCE CONSENTS WHICH SHOULD BE READ IN CONJUNCTION WITH THE DECISION

YOUR RIGHTS OF OBJECTION

If you do not agree with the Council's decision on this non-notified resource consent, any of its conditions, or any additional fees that have been charged, you may, pursuant to Section 357 of the Resource Management Act 1991, lodge an objection with the Council. The notice of objection must be received by the Council within 15 working days of receipt of the decision.

COMMENCEMENT OF CONSENT

The commencement date for your resource consent is the date of this letter or the date of the fax advising you of the Council's decision whichever occurs first, unless you lodge an objection against the decision. The commencement date will then be the date on which the decision on the objection is determined.

MONITORING

Where appropriate, the Council monitors resource consents to ensure the conditions are complied with and that the development proceeds in accordance with plans and details which were submitted with the application. The costs incurred in carrying out any monitoring, where required, will be charged to the consent holder.

LAPSING OF THIS CONSENT

This consent will lapse five years after the date of its commencement, unless on receipt of a further application under Section 125 of the Resource Management Act, the Council extends this 5 year period.

Any development authorised by a resource consent must be completed within the 5 year period in order that it is lawfully established. Any proposal that is not fully implemented and completed within 5 years will require either a new resource consent or an extension of time.

Applications for an extension of the duration of a consent are required to be assessed under Section 125 of the Resource Management Act before the Council can extend the duration of any consent.



32 Annex Road

Land Use Consents

Scale 1:2500

Automated Mapping by Christchurch City Council, Geodata Services



32 Annex Road

Subdivision Consents

Scale 1:2500

Automated Mapping by Christchurch City Council, Geodata Services

Spatial Query Report



Land Use Resource Consents within 250 metres of 32 Annex Road

Note, This map does not include Subdivision Consents and Certificate of Compliance issued under the Resource Management Act.

Address: 1 LINCOLN ROAD

Consent Type: Activity: Discretionary Activity

Reference: 960622 **Status:** Completed **Decision:** Granted

Date Received: 15 March 1996 **Date of Decision:** 10 April 1996

Description:

To remove a Cedrus Atlantica ``glauca`` from the above site,.

Consent Type: Notified Application **Activity:** Discretionary Activity

Reference: 20002991 **Status:** Completed **Decision:** Granted

Date Received: 4 September 2000 **Date of Decision:** 13 November 2000

Description:

Application to establish a new co-educational independent secondary college.

Consent Type: Requirement/Outline Plan **Activity:** Outline Plan

Reference: 20003142 **Status:** Completed **Decision:** Granted

Date Received: 21 September 2000 **Date of Decision:** 20 December 2000

Description:

Replace existing security fence.

Consent Type: Non-Notified Application **Activity:** Controlled Activity

Reference: 20003225 **Status:** Completed **Decision:** Granted

Date Received: 29 September 2000 **Date of Decision:** 5 December 2000

Description:

4 LOT FEE SIMPLE SUBDIVISION.

Consent Type: Activity:

Reference: 20002048 **Status:** Withdrawn **Decision:**

Date Received: 24 May 2000 **Date of Decision:**

Description:

Application for removal of two notable trees: Quercus robur (Tree 24) and Fraxinus excelsior (Tree 28).

Consent Type: Non-Notified Application **Activity:** Non-Complying Activity
Reference: 92005845 **Status:** Completed **Decision:** Granted
Date Received: 31 July 2006 **Date of Decision:** 29 September 2006
Description:
 To erect three temporary freestanding signs.

Consent Type: **Activity:** Non-Complying Activity
Reference: 991466 **Status:** Completed **Decision:** Granted
Date Received: 17 May 1999 **Date of Decision:** 28 May 1999
Description:
 Application for an energy centre containing two gas fired boilers, a 12 tonne LPG tank, four vaporisers and associated pipework.

Consent Type: **Activity:** Non-Complying Activity
Reference: 962106 **Status:** Completed **Decision:** Granted
Date Received: 9 August 1996 **Date of Decision:** 24 April 1997
Description:
 Application to process non-hospital laundry with hours of operation up to a maximum of 24 hours per day, 7 days per week, in conjunction with an existing commercial laundry processing hospital sector laundry.

Consent Type: **Activity:** Non-Complying Activity
Reference: 971429 **Status:** Completed **Decision:** Granted
Date Received: 29 May 1997 **Date of Decision:** 16 October 1997
Description:
 Application for a creative village which involves rehabilitation and Craft cooperative activities for residents of Sunnyside Hospital and former patients and other artisans who live in the community, together with retailing of goods grown and.

Consent Type: **Activity:** Non-Complying Activity
Reference: 980809 **Status:** Completed **Decision:** Granted
Date Received: 26 March 1998 **Date of Decision:** 11 May 1998
Description:
 Application for a chimney stack associated with a boiler house which exceeds the 14m maximum height limit i. e. 21m proposed and also intrudes the recession plane.

Consent Type: **Activity:** Non-Complying Activity
Reference: 982498 **Status:** Completed **Decision:** Granted
Date Received: 14 September 1998 **Date of Decision:** 9 November 1998
Description:
 Application for a creative village which involves work rehabilitation and Craft CO-operative activities for residents of Sunnyside Hospital and former patients and other artisans in the community, together with retailing of goods grown and pr.

Consent Type: Activity: Non-Complying Activity
Reference: 982540 **Status:** Completed **Decision:** Granted
Date Received: 17 September 1998 **Date of Decision:** 2 November 1998
Description:

Application for an energy centre, containing two gas fired boilers, a 12 tonne LPG tank and ancillary equipment and pipework.

Consent Type: Activity: Outline Plan
Reference: 982665 **Status:** Completed **Decision:** Granted
Date Received: 17 September 1998 **Date of Decision:** 2 October 1998
Description:

Application for an Outline Plan for Sunnyside Hospital.

Consent Type: Activity: Discretionary Activity
Reference: 983263 **Status:** Completed **Decision:** Granted
Date Received: 4 December 1998 **Date of Decision:** 9 December 1998
Description:

Application to carry out ground works in the vicinity of 11 protected trees located on the Sunnyside Hospital grounds.

Consent Type: Activity: Discretionary Activity
Reference: 990655 **Status:** Completed **Decision:** Granted
Date Received: 10 March 1999 **Date of Decision:** 25 March 1999
Description:

Application to remove a Monkey Puzzle tree (Araucaria Araucana) which has died.

Address: 19 SYLVAN STREET

Consent Type: Non-Notified Application Activity: Controlled Activity
Reference: 9487 **Status:** Completed **Decision:** Granted
Date Received: 26 August 1999 **Date of Decision:** 4 October 1999
Description:

Fee Simple SUBDIVISION 223 received 22/11/99 Certified 23/11/99 224 requested 9/2/99
 Issued 14/2/99 DP 82003.

Address: 21 SYLVAN STREET

Consent Type: Non-Notified Application **Activity:** Discretionary Activity
Reference: 20005066 **Status:** Completed **Decision:** Granted
Date Received: 11 May 2001 **Date of Decision:** 25 May 2001

Description:

Application to erect and use an und LPG storage tank & associated facilities in conjunction with an existing commercial laundry.

Consent Type: Non-Notified Application **Activity:** Discretionary Activity
Reference: 20003982 **Status:** Completed **Decision:** Granted
Date Received: 3 January 2001 **Date of Decision:** 23 January 2001

Description:

Application to install and operate a 12 tonne LPG storage tank.

Address: 32 ANNEX ROAD

Consent Type: Non-Notified Application **Activity:** Non-Complying Activity
Reference: 20015287 **Status:** Completed **Decision:** Granted
Date Received: 6 November 2003 **Date of Decision:** 23 January 2004

Description:

Application to establish and operate a pre-school and retrospective sign at the corner of Annex Road and Lincoln Road.

Consent Type: Non-Notified Application **Activity:** Limited Discretionary
Reference: 20003684 **Status:** Completed **Decision:** Granted
Date Received: 23 November 2000 **Date of Decision:** 29 March 2001

Description:

FEE SIMPLE SUBDIVISION - 72 LOTS.

Address: 68 ANNEX ROAD

Consent Type: Non-Notified Application **Activity:** Controlled Activity
Reference: 20015782 **Status:** Completed **Decision:** Granted
Date Received: 13 January 2004 **Date of Decision:** 25 February 2004

Description:

BOUNDARY ADJUSTMENT 223 requested 15/2/05 issued 10/03/05 224 Requested 21/03/05 issued 28/4/05 DP 349157.

Data Quality Statement

Land Use Consents

All resource consents* are shown for sites that have been labeled with an address. For sites that have been labelled with a cross (+) no resource consents have been found. Sites that have no label have not been checked for resource consents. This will be particularly noticeable on the margins of the search area radius. If there are such sites and you would like them to be included in the check, please ask for the LIM spatial query to be rerun accordingly. This will be done free of charge although there may be a short delay. Resource consents which are on land occupied by roads, railways or rivers are not, and currently cannot be, displayed, either on the map or in the list. Resource consents that relate to land that has since been subdivided, will be shown in the list, but not on the map. They will be under the address of the land as it was at the time the resource consent was applied for. Resource consents that are listed as Non-notified and have a status of current, may in fact be notified resource consents that have not yet been through the notification process. If in doubt, please phone (03)9418657.

* The term "resource consents" in this context means land use consents. Subdivision consents and certificates of compliance are excluded.

Subdivision Consents

All subdivision consents* are shown for sites that have been labelled with an address and consent details. For sites that have been labelled with a cross (+) no records have been found. Sites that have no label have not been checked for subdivision consents. This will be particularly noticeable on the margins of the search area radius. If there are such sites and you would like them to be included in the check, please ask for the LIM spatial query to be rerun accordingly. This will be done free of charge although there may be a short delay.

* The term "subdivision consents" in this context means a resource consent application to subdivide land. Non subdivision land use resource consents and certificates of compliance are excluded.

This report will only record those subdivision applications which have not been completed and new properties have not been created in the council's property database; i.e. once a subdivision has been given effect to and the new lots/properties have been established the application which created those lots will not be shown.

All Subdivision Consent information is contained on the map and no separate list is supplied.